

## EGN100 / EGN200 / EGN400

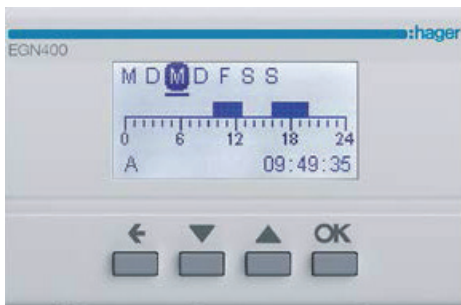

### quick start guide

Time switches

1 channel / 2 channel / 4 channel

Bluetooth® multifunction  
with the Hager Mood app

# Contents

1. Introduction.....	2	6. Adding program steps.....	9
2. Setting up your installation.....	2	7. The "AND" logical operator (EGN100/200/400).....	11
3. Connecting a time switch (EGN100/200/400) for the first time.....	4	8. Programming the twilight switch.....	12
4. Creating a new program.....	6	9. RF-Quicklink connection.....	15
5. Loading a program from the app to the clock key (EGN103 and EGN003).....	7	10. Integration with Coviva (TKP100A/Coviva app).....	21
		11. Updating device firmware.....	24

## 1. Introduction

Our EGN100, EGN200 and EGN400 electronic time switches feature weekly and yearly cycles for automatic control of different lighting loads.

**Examples of applications:** public lighting, illuminated signs, shop windows, monuments, facades etc.

- **Built-in astronomical clock** allows lighting times to be synched to **sunset** and **sunrise**.
- Connects to an EEN002 / EEN003 / EEN003W **twilight sensor** (optional), allowing lighting to be controlled according to the level of ambient **brightness**.

## 2. Setting up your installation

1 Download the free **Hager Mood** app to your mobile device:



Hager Mood



for Android



for IOS



for Windows

2 Make sure the **Bluetooth**, **Location** and **Mobile Data** settings are enabled:

Tap the **Settings** icon on your mobile device, select **Apps**, then **Hager Mood**:

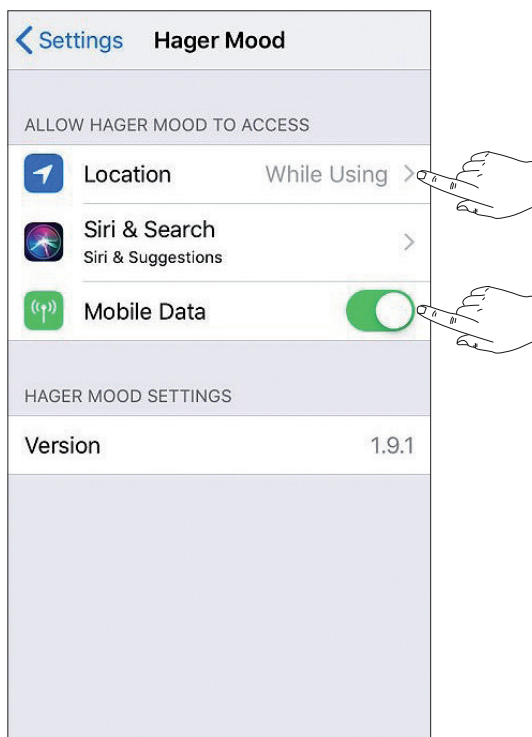

Swipe downwards and then tap **Bluetooth** to enable it.

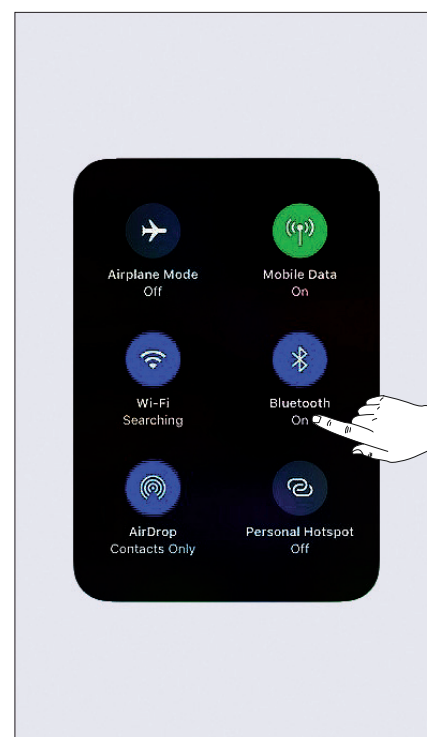

3 Log in to your myHager account (or enter in **Guest mode**), or **Create an account**. Then **confirm** ✓.



4 Assign a name and location to the new installation, then hit **Next**.

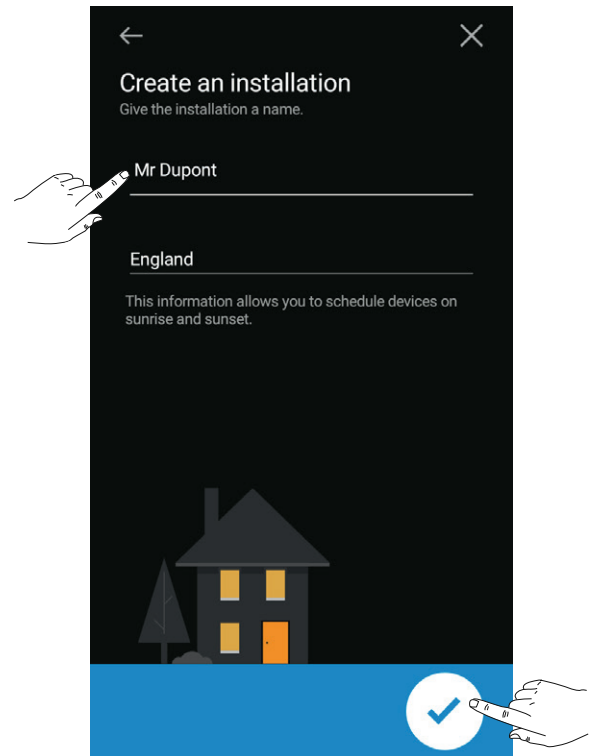

5 Select **Time switches** and hit **confirm**.

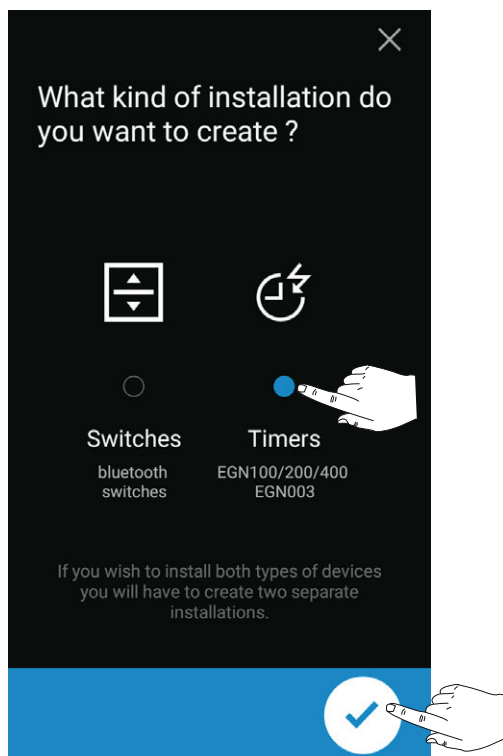

6 You are now in the home screen of your installation.

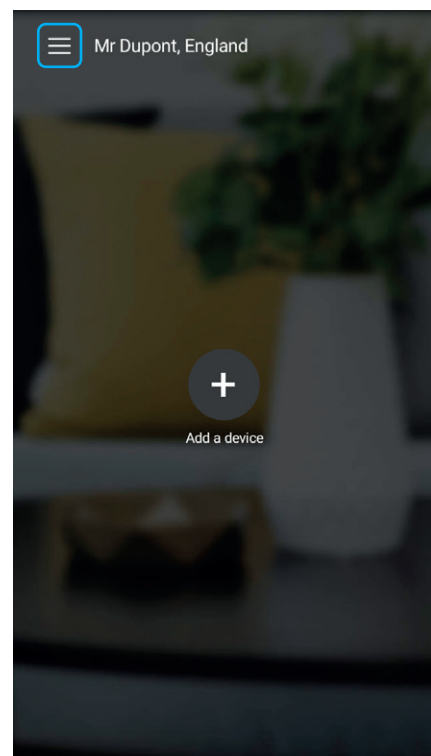

### 3. Connecting a time switch (EGN100/200/400) for the first time

- 1
- ① Connect the time switch to the mains power supply.
  - ② On the home screen, touch **+** to add a device.

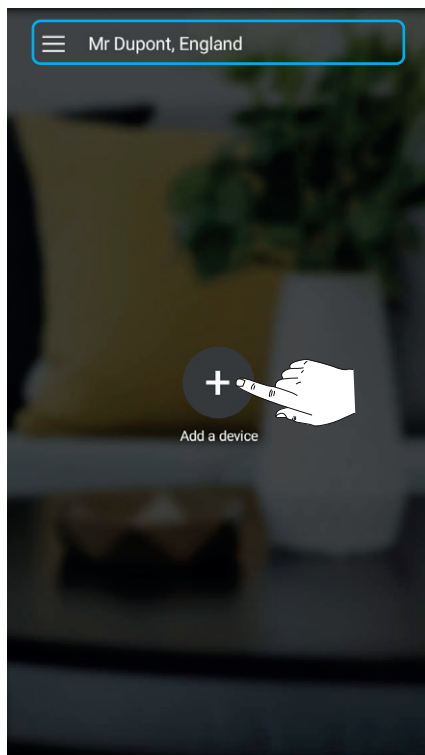

- 2
- Touch the **icon** of the discovered device to connect to the time switch.

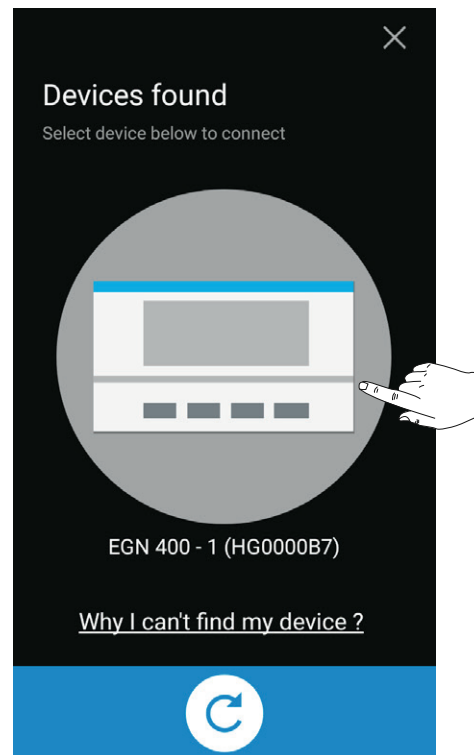

- 3
- Accept the pairing of your mobile terminal with the time switch.

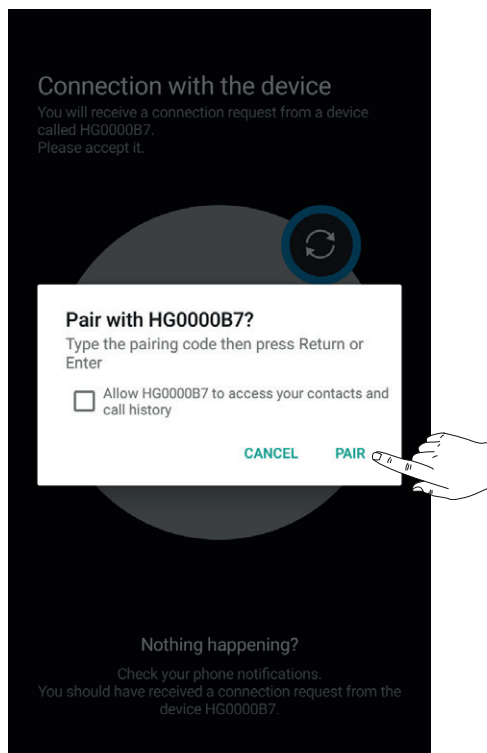

#### Having trouble connecting?

- Check **Notifications** and follow the instructions. Otherwise:

- Go to the **Bluetooth Settings on your mobile device**:

- ① disable then re-enable Bluetooth and **wait for the scan to complete**
- ② check the settings of your time switch and make it visible for discovery if necessary; **then wait a few seconds**
- ③ return to the app and tap the icon of the discovered device.

4 Press any button on the time switch.

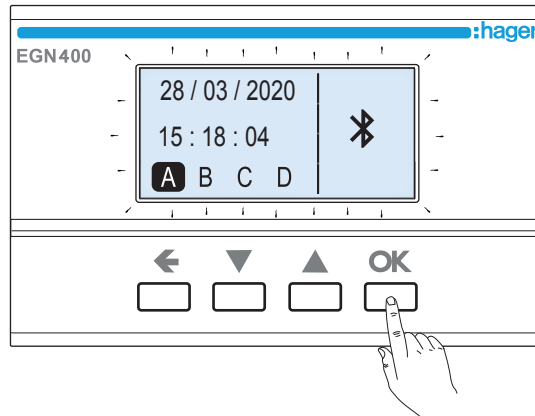
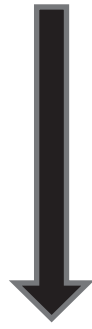

5 The device has been identified. Touch the **arrow key**, give a name to the product if necessary, and then **confirm**.

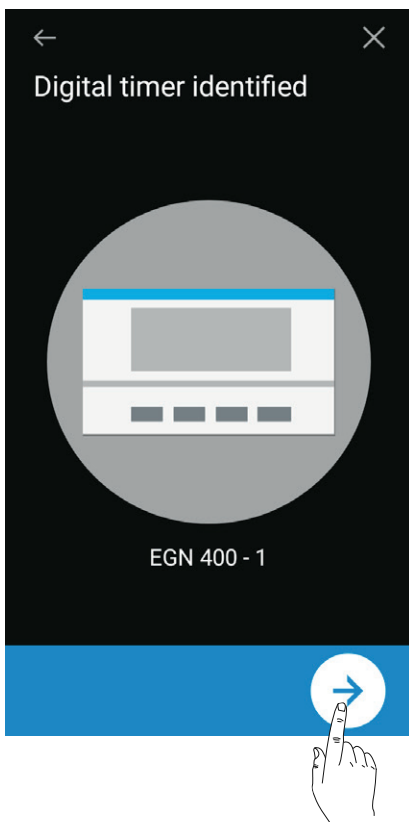

6 To return to the home screen, double-tap the **X** key (or tap the **+** key to create a new program: see next section).

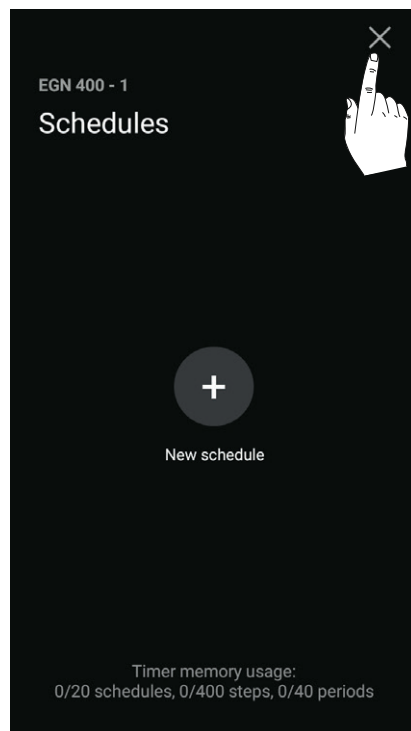

7 The device has now been added to the home screen.

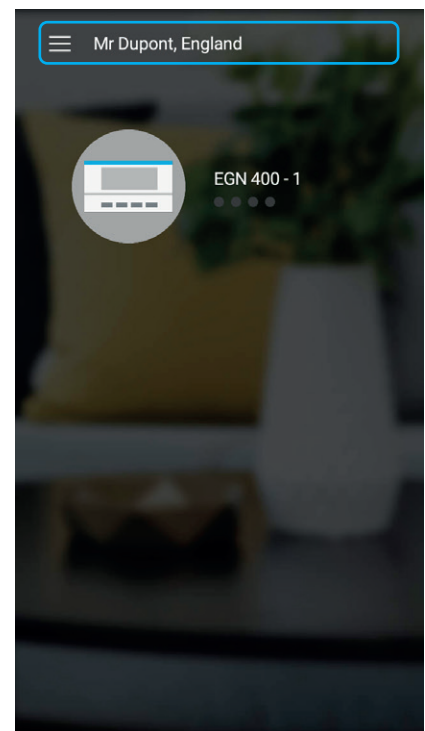

## 4. Create a new program

To create a new program (custom or template):

- 1 On the home screen, tap the **icon** of the device you wish to programme.

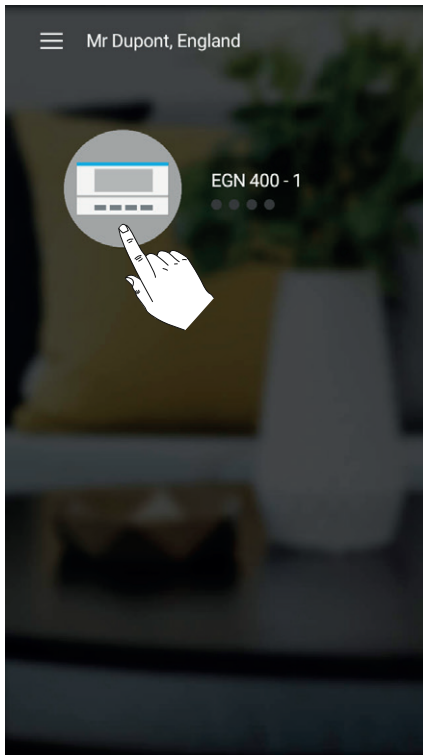

- 2 Tap **View programs**.

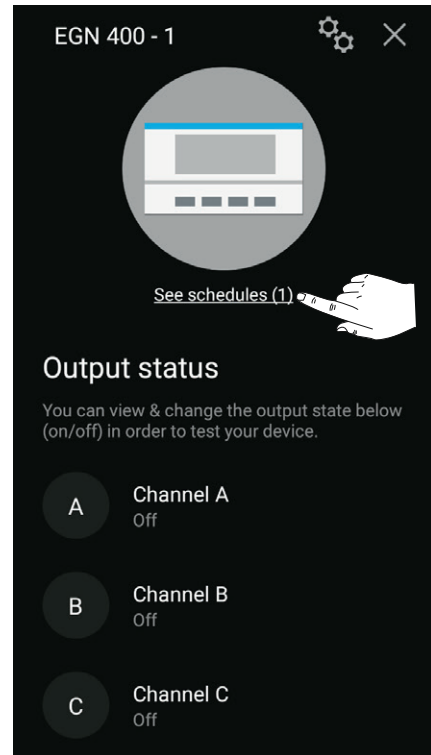

- 3 Tap **+** to add a new program. You can now choose whether to enter the program settings one by one, or select a template. Then **confirm**.

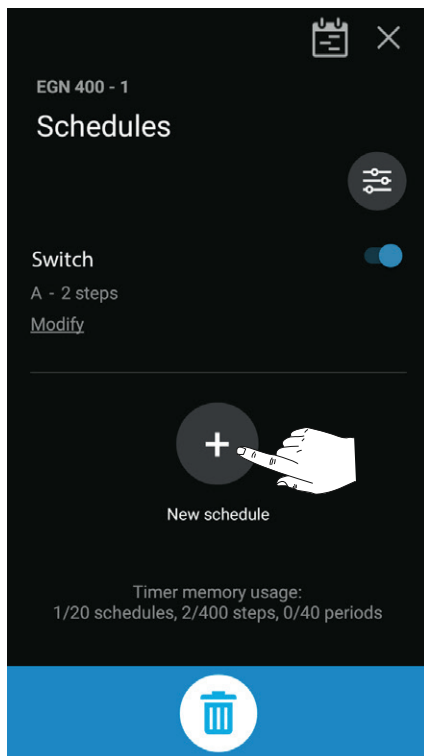

- 4 Select **the output(s)** available for programming and then tap the **arrow** (to add program steps, see section 6).

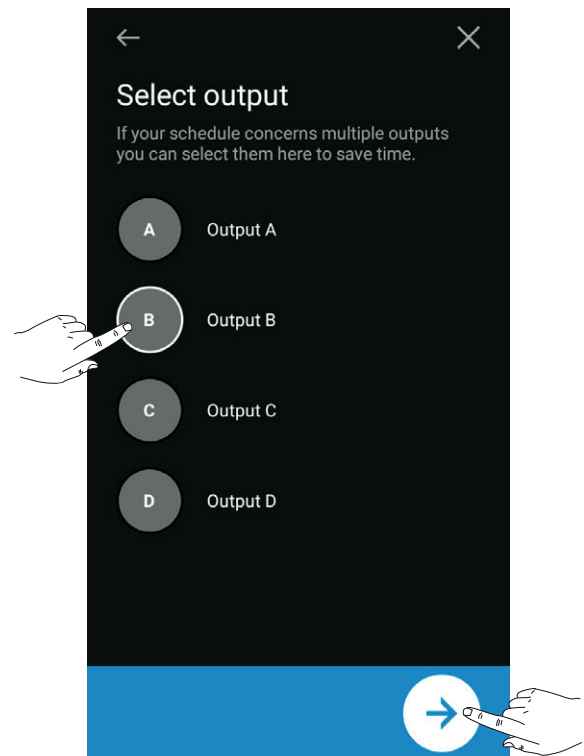

## 5. Loading a program from the app to the clock key (EGN103 and EGN003)

- 1 Connect the EGN003 Bluetooth® clock key to the EGN103 time switch.

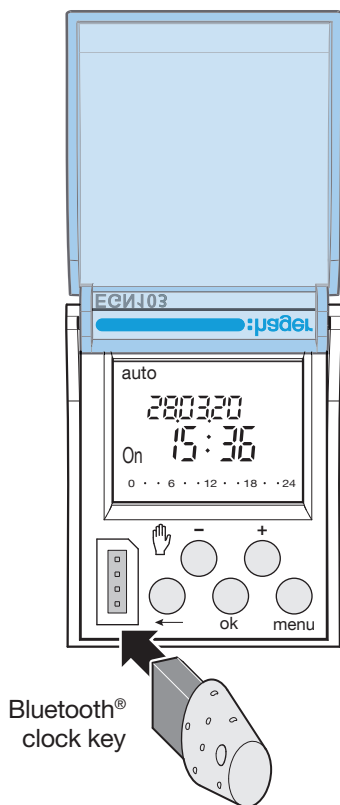

- 2 Once the key has been discovered, pair it to your mobile device using the **Hager Mood** app.

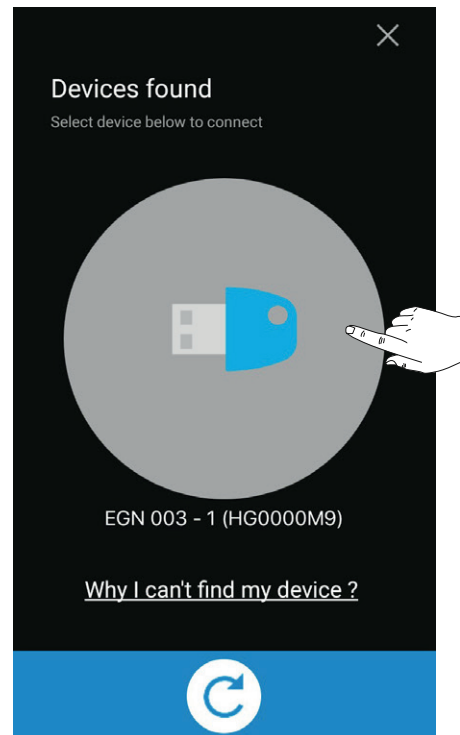

- 3 ① To create a new program: on the home screen, touch the clock key **icon** and enter the program settings one by one, or use a clock key template (see section 4).  
② To **add steps** to a program, see section 6.

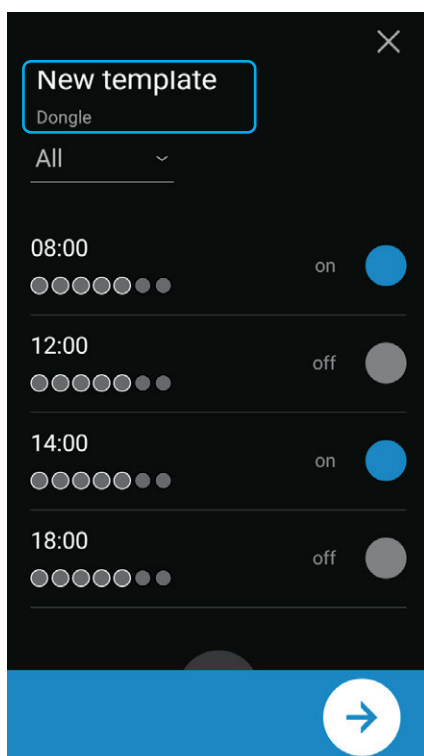

- 4 Load the program onto the clock key.

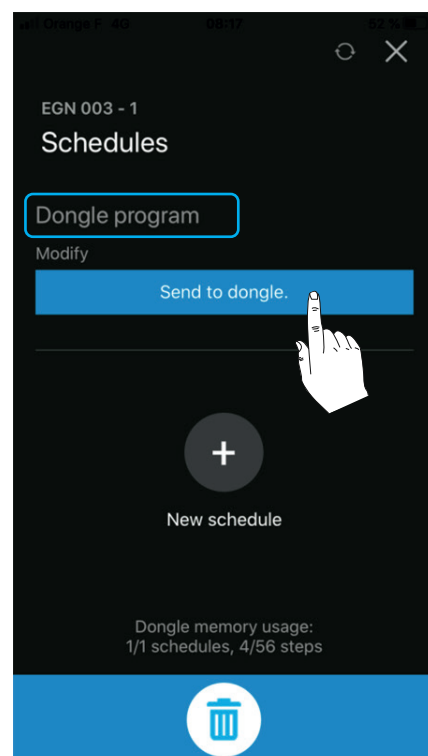

- 5 The program is now stored on the key.  
The program will run as configured for as long as the key remains in the time switch.  
Before removing the key from the time switch, you must manually load it onto the EGN103 time switch as described below.

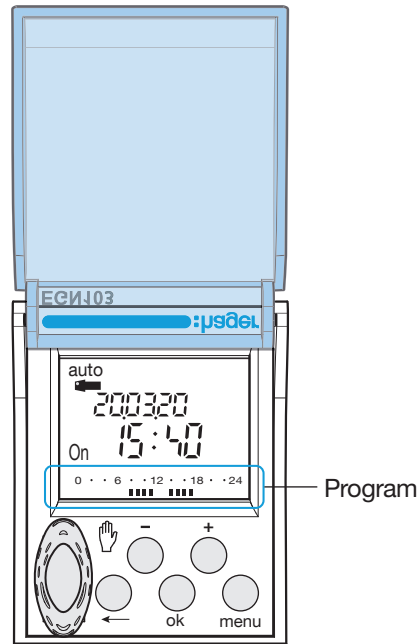

- 6 To load the program contained in the key onto the EGN103 time switch:
- 1 press the **menu** button, select **LOAD** mode then press **OK** to confirm
  - 2 press **OK** again to load the program
  - 3 remove the key and check the program is present in the EGN103 time switch.

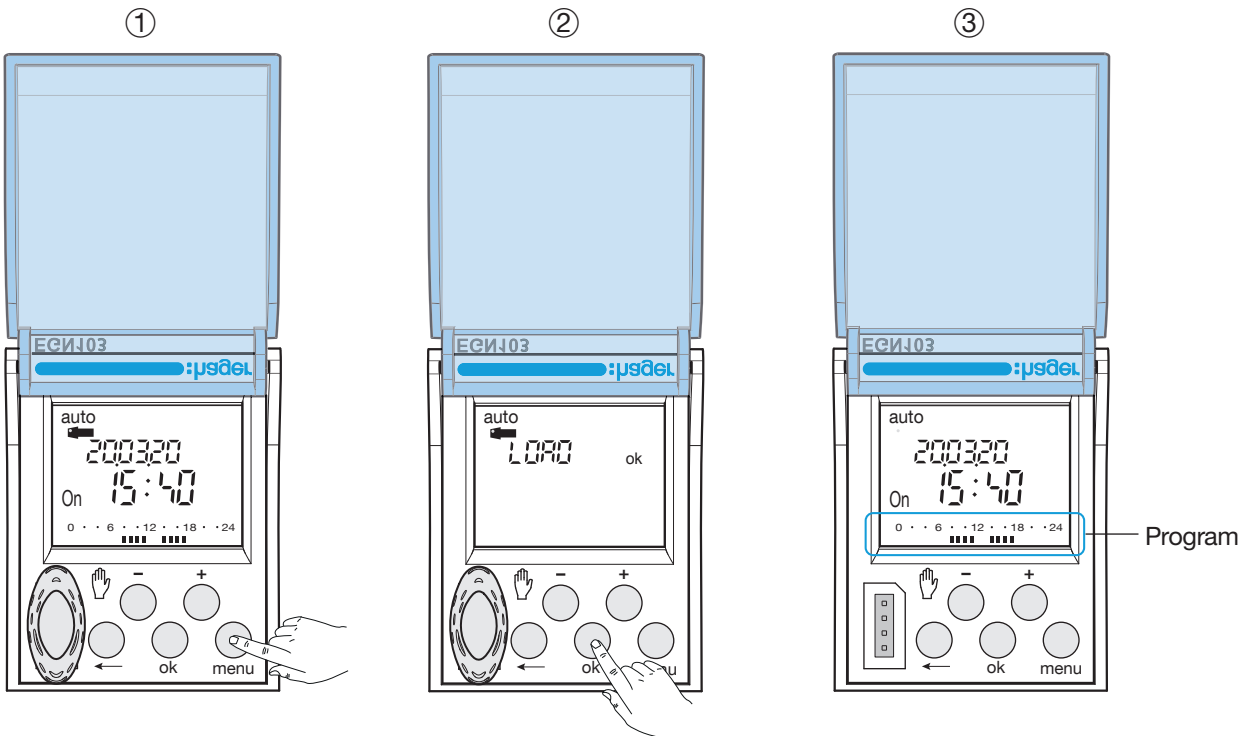



## 6. Adding program steps

- 1 ① Create a new program (see section 4).
- ② Click on **+** to add a program step.

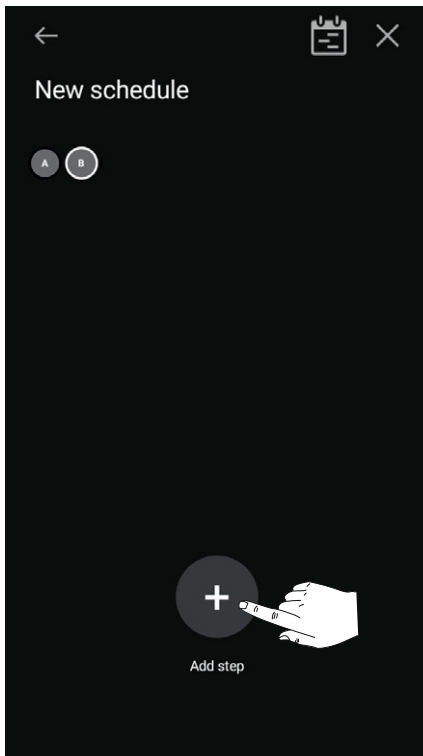

For each new step, you must define a **an action plus a trigger**, and **the days** you want the step to be executed, as applicable:

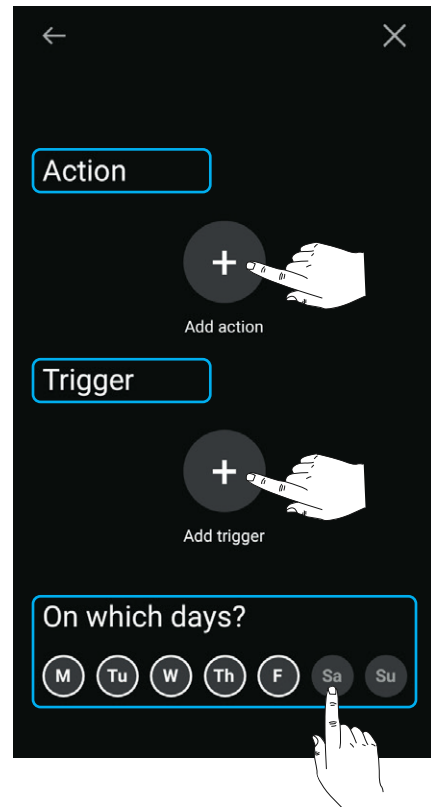

### 2 To select an action:

- ① tap **+** to add an action
- ② select **one** of the **actions** below, **adjust its setting** as required, then tap the **confirm** button.

#### Actions available per device and setting:

##### • EGN003

Action
On
Off

##### • EGN100/200/400

Action	Setting
On	
Off	
On For a limited time (pulse)	1 to 60 seconds
Off For a limited time (pulse)	1 to 60 seconds

#### Example: Pulse On for 60 seconds

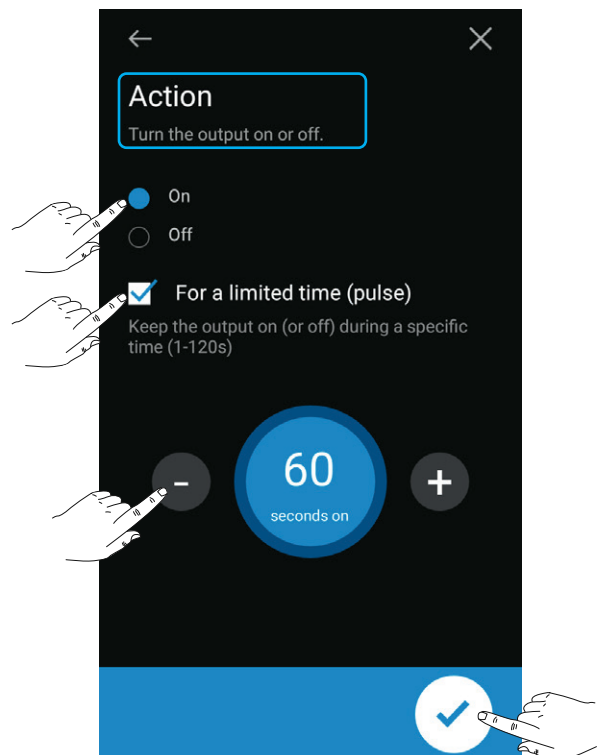

**3 To select a trigger:**

- ① tap **+** to add a trigger
- ② select **one** of the **triggers** listed below, then tap the **blue arrow**
- ③ use the + and - buttons to set the trigger **values**, then tap **OK** to confirm if necessary, followed by the **blue arrow** to continue.

**Trigger available by device and setting:**

• EGN003

Trigger	Setting
Time	Hours and minutes

• EGN100/200/400

Trigger	Setting	
Time	Hours and minutes	
Sunset/Sunrise	At sunset or At sunrise	
Brightness	Lower than or Higher than	value between 1 and 2000 lux

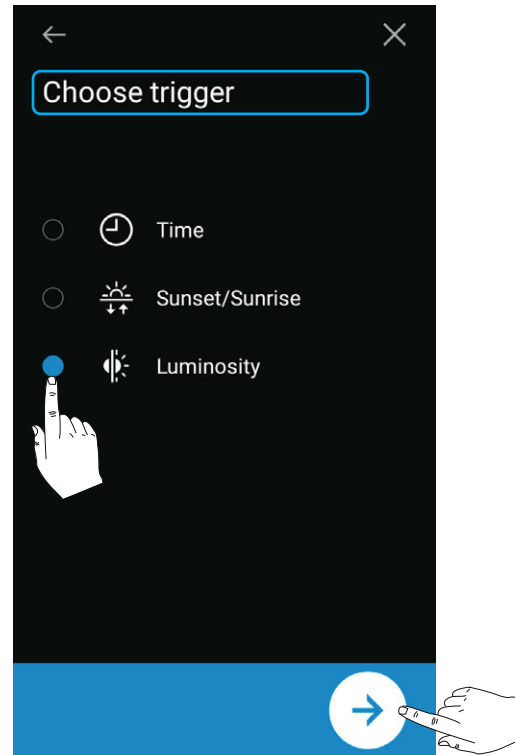

**4 To select the days:**

The step is executed on every day with a white circle around it. Tap the **days** to select them, then **confirm**.

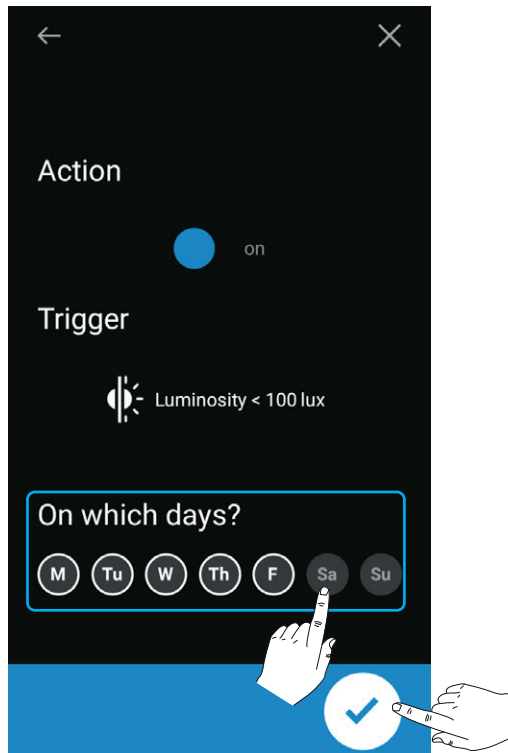

**5**

**The step is programmed. Tap **+** to add another step to the program.**

**(After the final step: confirm your settings, assign a name to the program, then synchronize it with the device - see example in section 8)**

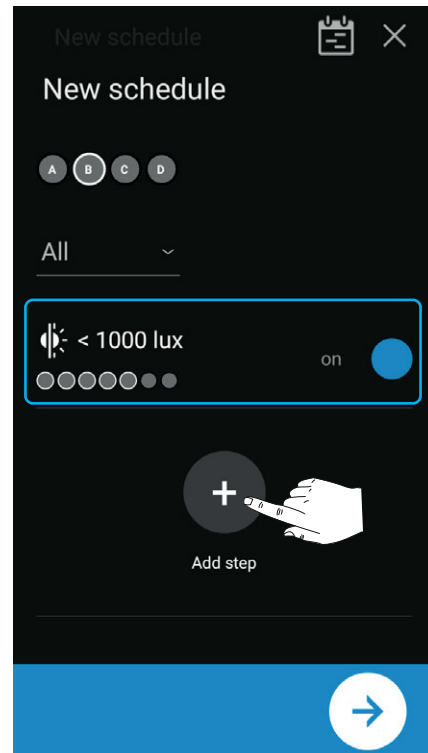

**6** Once the program is synchronized with the device, **you need to implement AND logical operators between the steps: see next section for instructions.**

## 7. The "AND" logical operator (EGN100/200/400)

- 1 On the home screen, tap the **device icon** and then **device settings**.

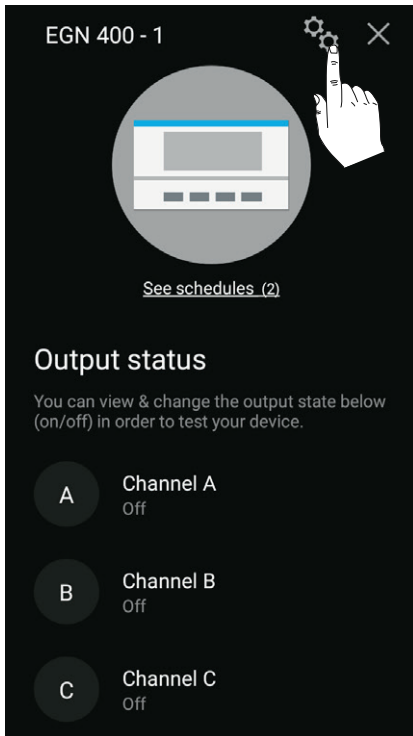

- 2
- ① Tap to open the **Date and Time** drop-down menu.
  - ② Slide the **Activate special mode** button to the "on" position.
  - ③ Select the output(s) concerned.

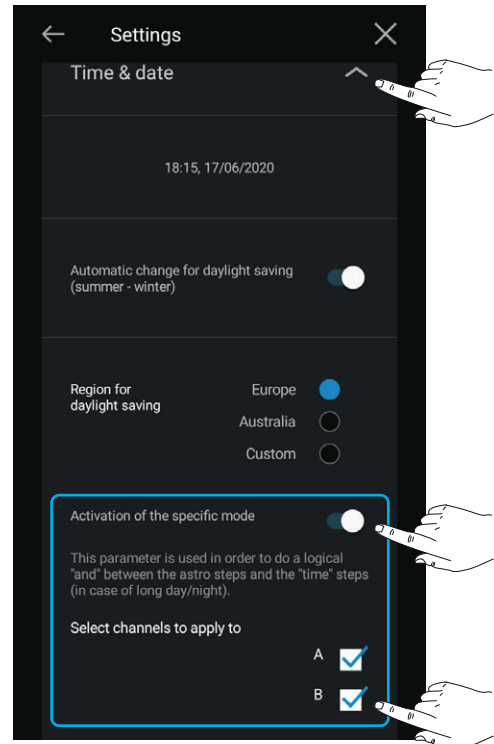

The time switch implements the **"AND"** logical operator between **all steps in the same program**.



**For example**, on the screen below we want to:

- switch on the light when **the brightness is below 100 lux**, at **6 am**, **AND** at **sunset (8:25 pm) = ON** and
- switch off the light when **the brightness is above 100 lux**, at **sunrise (6:32 am) AND** at **11:00 pm = OFF**

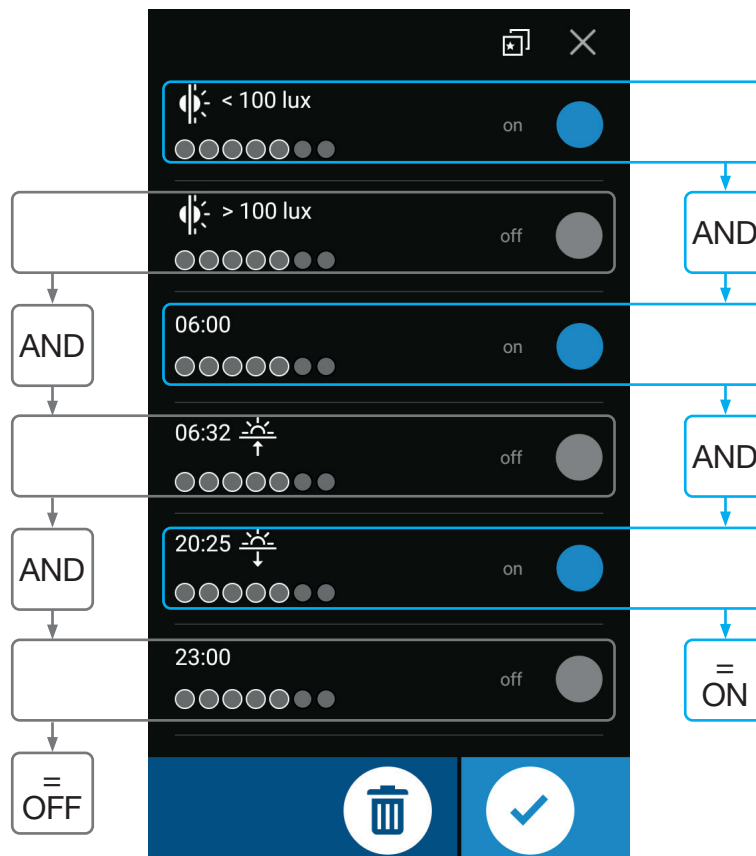

## 8. Programming the twilight switch

**Example:** We want to switch on the light when the brightness is below 100 lux (**step 1**), and switch it off when the brightness is above 100 lux (**step 2**), from Monday to Friday, on output B. To do this:

1 Create a new program (see section 4).

2 Program step 1: switch on light when **brightness** is **below** 100 lux.

① Add a step.

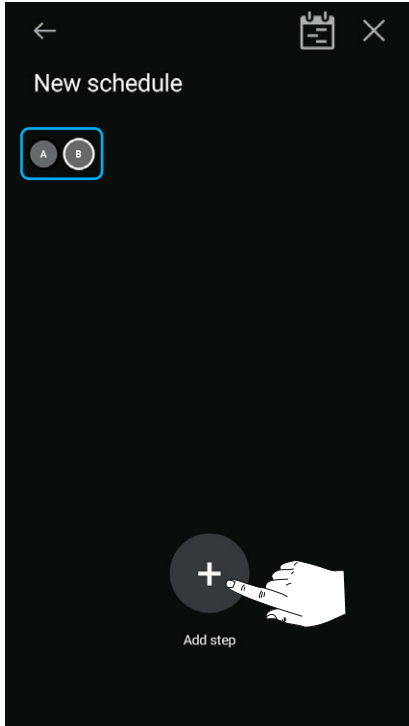

② Add an action.

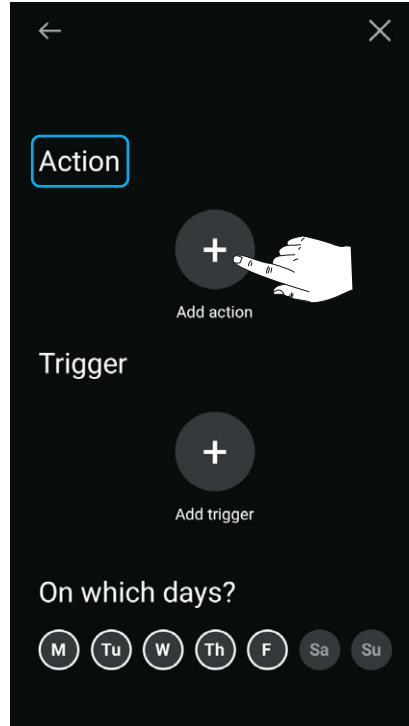

③ Select "On" then confirm.

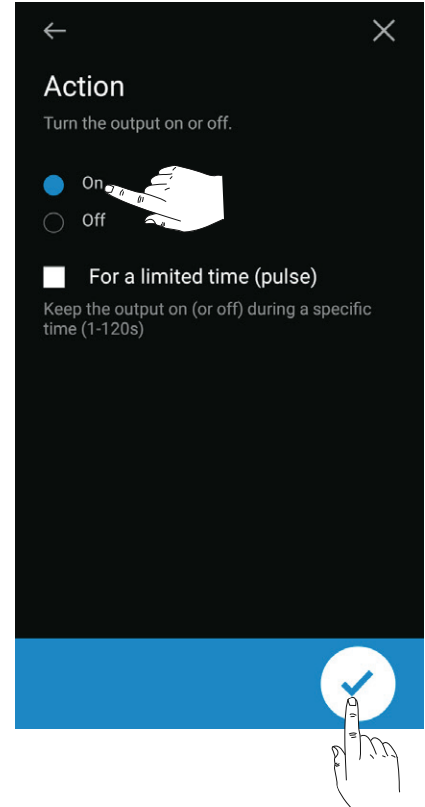

④ Add a trigger.

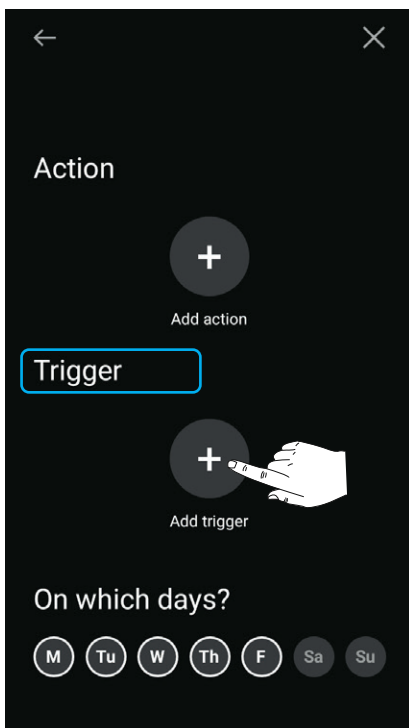

⑤ Select the **Brightness** trigger then tap the **arrow** to move to the next page.

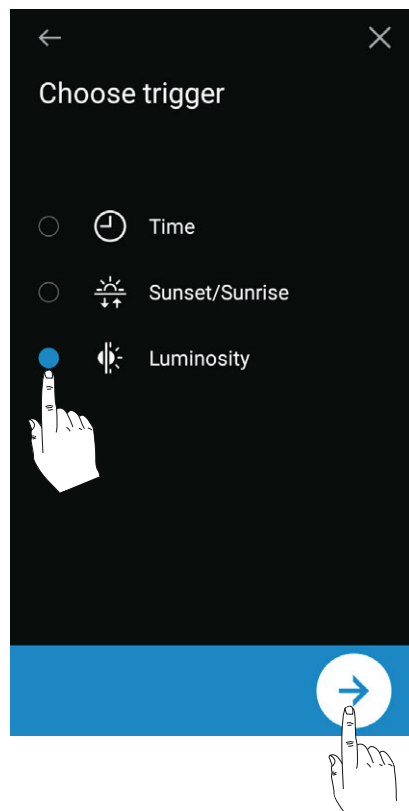

⑥ Select the **Lower than** function and set its value to **100 lux**. Then tap the **arrow** to confirm.

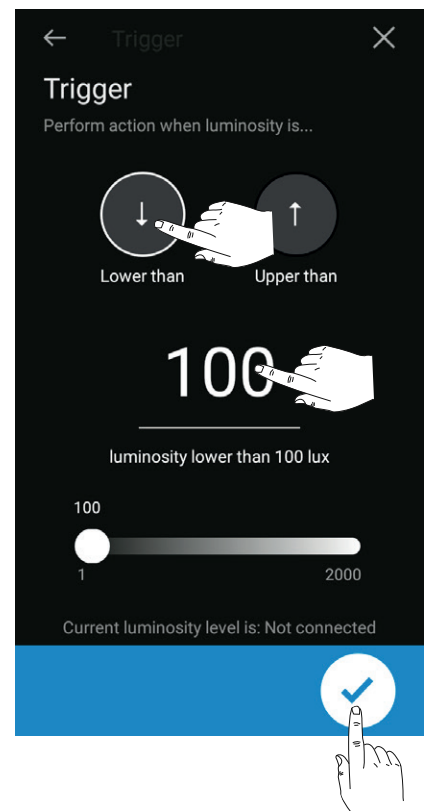

3 Program step 2: switch offlight when **brightness** is above 100 lux.

① Add a step.

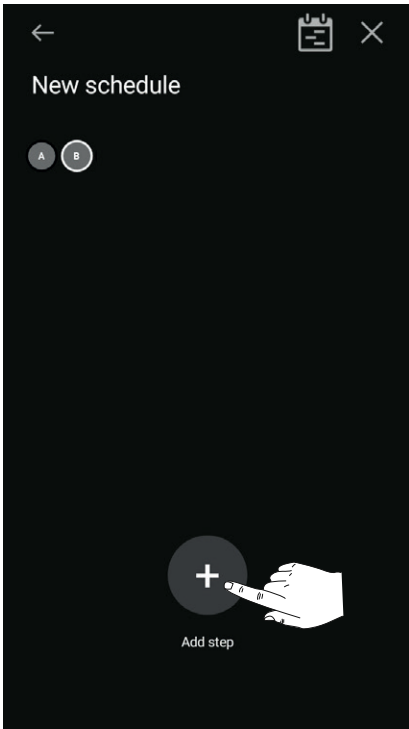

② Add an action.

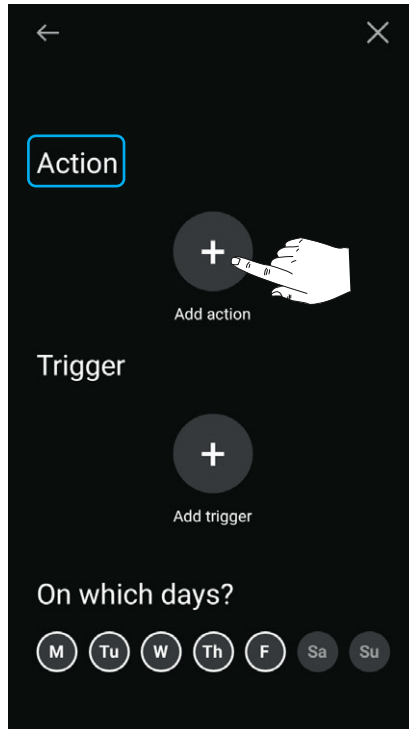

③ Select "Off" then confirm.

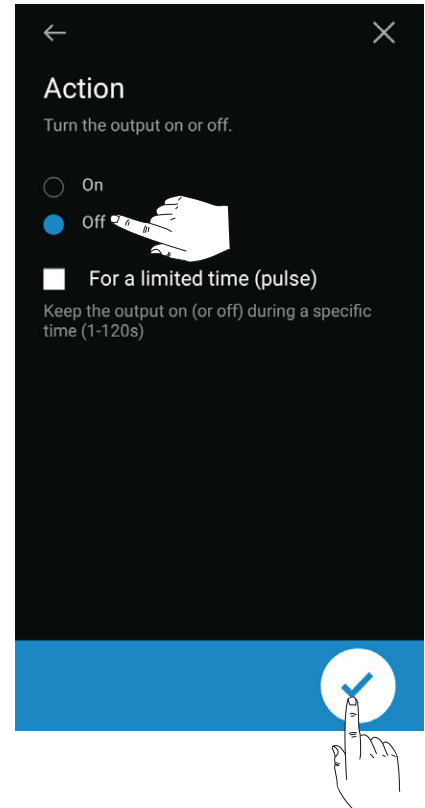

④ Add a trigger.

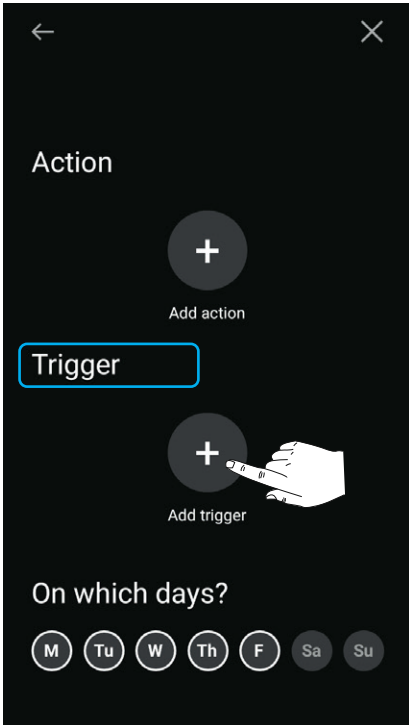

⑤ Select the **Brightness** trigger then tap the **arrow** to move to the next page.

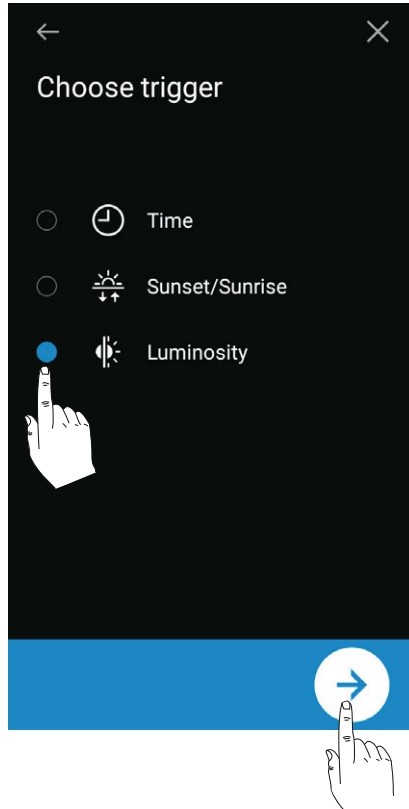

⑥ Select the **Higher than** function and set its value to **100 lux**. Then tap the **arrow** to confirm.

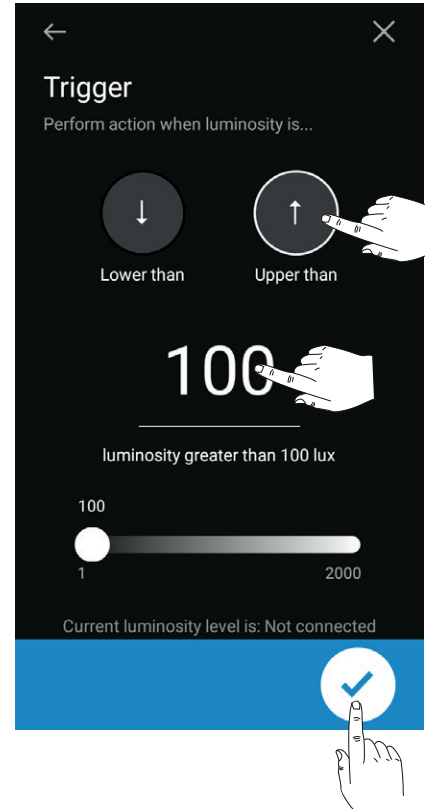

4 **Synchronizing the program with the device:**

① Check the **2 steps** of the new program created on output **B** then tap the **arrow** to move to the next page.

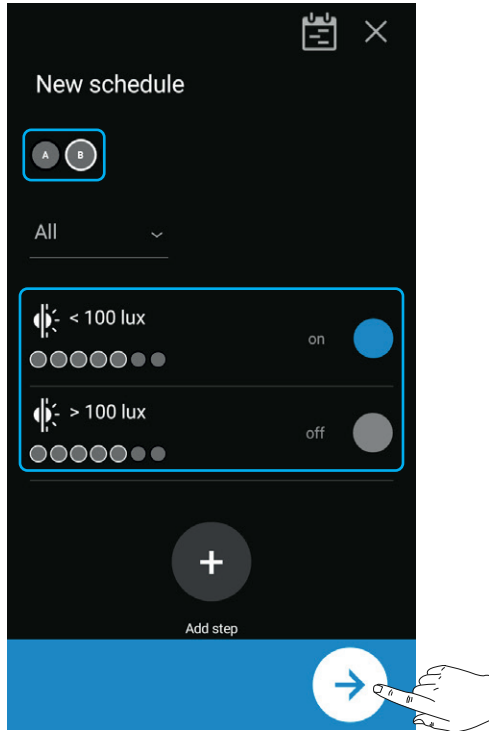

② Give a **name to the program** then **confirm** your choice.

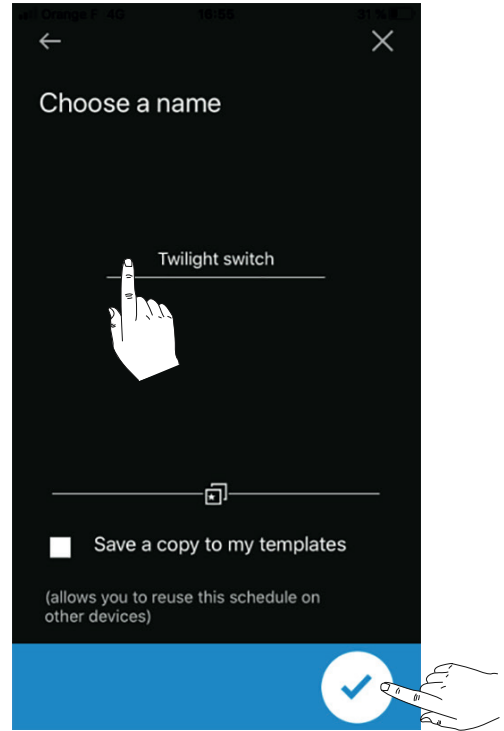

③ Tap **Synchronize device** to save the new program to the time switch (to return to the home screen, double-tap **X**).

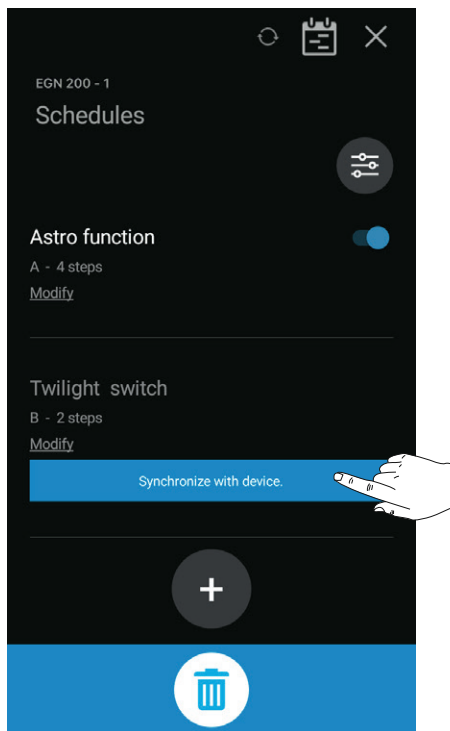

## 9. RF-Quicklink connection

The **RF link** allows the output(s) (A..D) of the time switch (receiver) to be associated with one or more Quicklink radio comfort devices (input(s)/transmitter).

### 9.1. Configuration with a control product (remote control, push button, KNX module...)

- 1 Enter configuration mode by **pressing and releasing** the **cfg** pushbutton on the input device.



**i** All time switches (output) enter configuration mode.

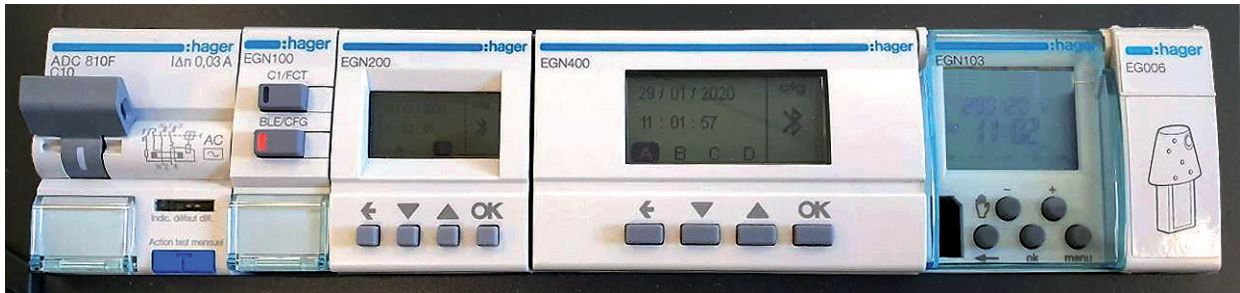

- 2 **Tap the input** which will control the time switch (output), then continue as required for the device concerned (EGN100 or EGN200/400) (1).

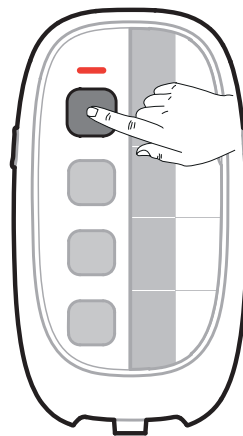

(1) For more information on inputs, scan the QR Code of one of the time switches at the end of the manual for details on configuration.

**For EGN100:**

**3** Repeatedly pulse the **FCT** key to select the function (1).

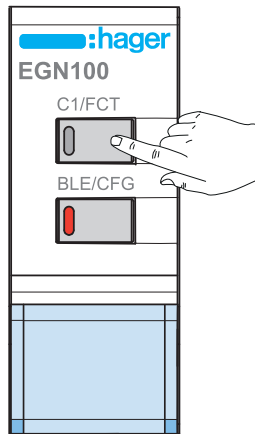

**4** Confirm your selection by **pressing** the **FCT** key and holding for at least 2 seconds.

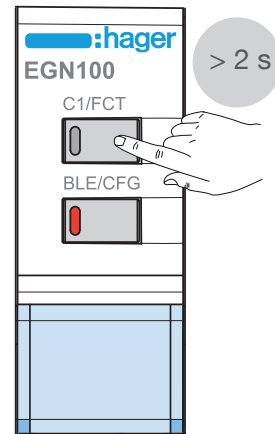

**5** Confirm the transmitter configuration by pulsing its **cfg** button.



(1) For more information on functions, scan the appropriate QR Code at the end of the manual for instructions on installing the device.



**For EGN200 and EGN400:**

**3** ① Open the **MENU**, ② select **Settings** then ③ press **OK** to confirm.

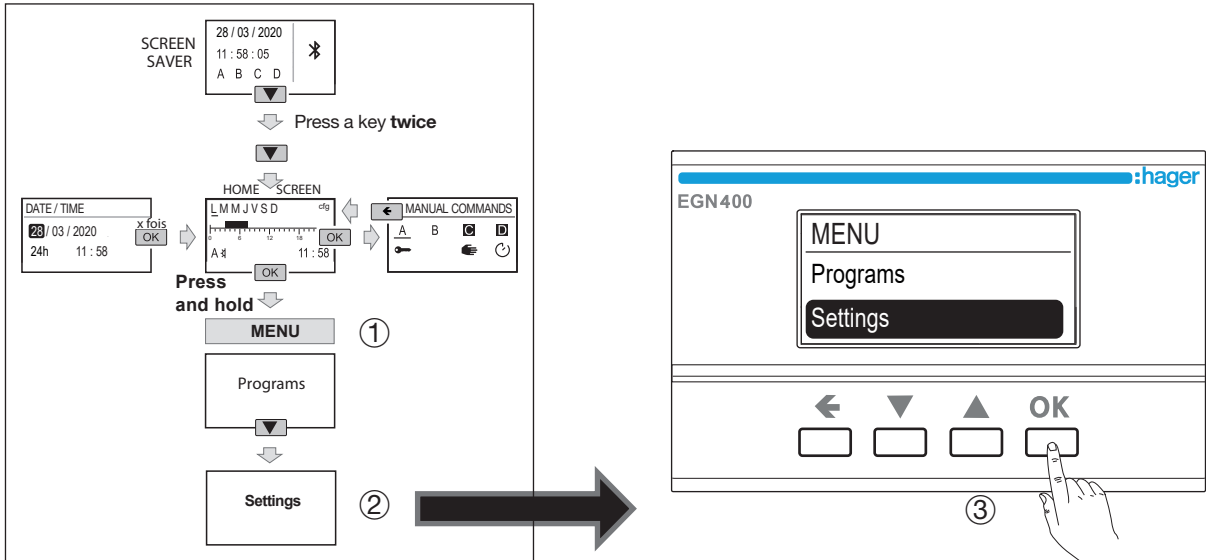

**4** Select **RF links**.

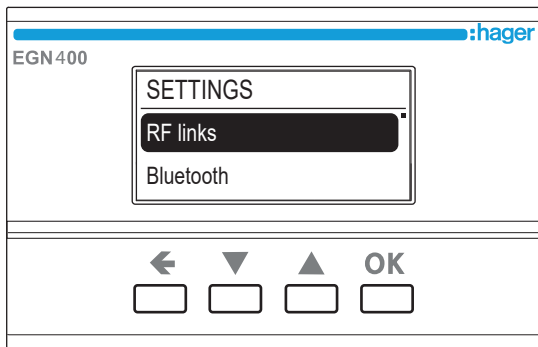

**5** Select the **output**.

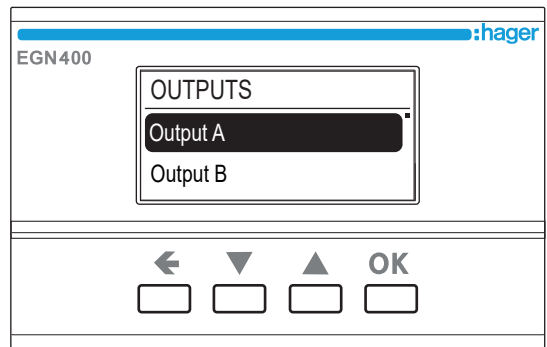

**6** Select the function, then press **OK** to confirm your selection and return to the **RF links** menu (1).

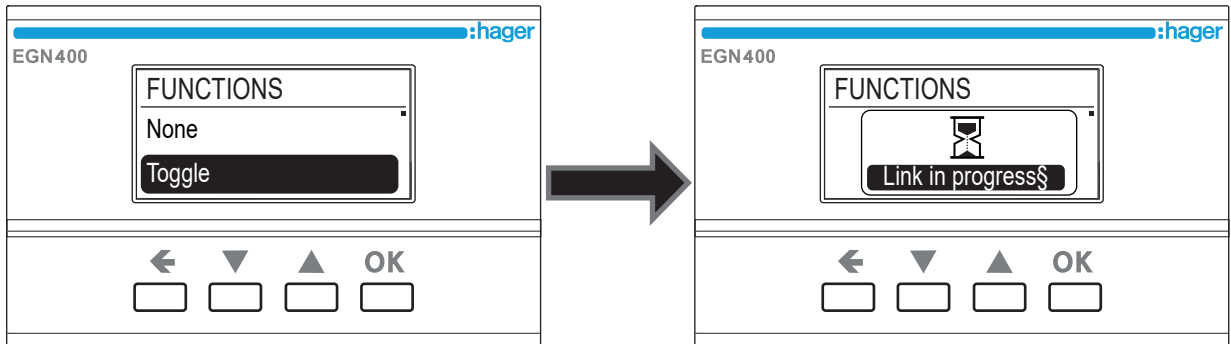

**7** Select the output. The symbol displayed indicates the link with the transmitter input (Quicklink radio comfort device) has been established.

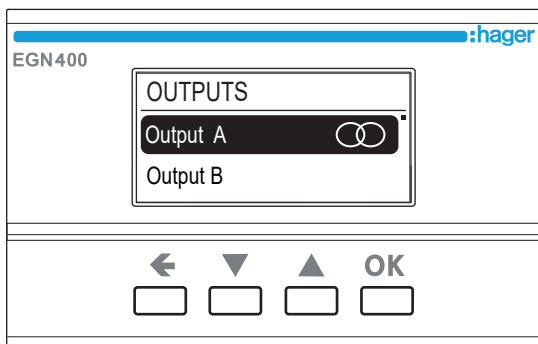

**8** Confirm the transmitter configuration by pulsing its **cfg** button.



(1) For more information on functions, scan the appropriate QR Code at the end of the manual for instructions on installing the device.

## 9.2. Configuration with EEN003W wireless luminosity cell

- 1 Enter configuration mode by **pressing and releasing** the **cfg** pushbutton on the input device.

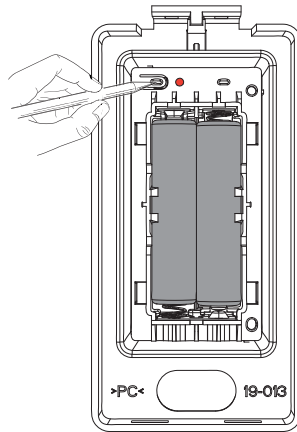

- i** All time switches (output) enter configuration mode.

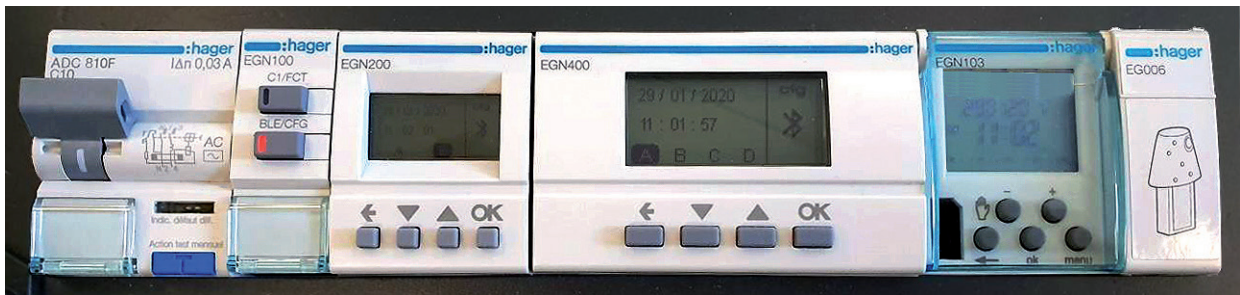

- 2 **The input is automatically selected.** Continue as required for the device concerned (EGN100 or EGN200/400).

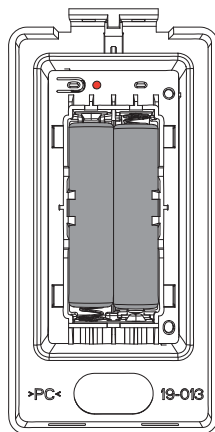

**For EGN100:**

**3** Push on the **FCT** key, will automatically select you the "Luminosity" function (**FCT LED** lights up red).

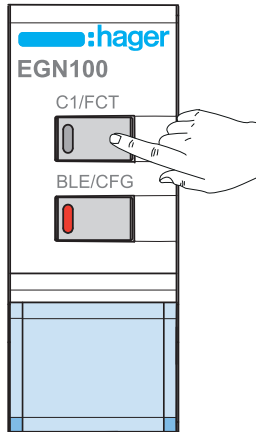

**4** Confirm your selection **by pressing** the **FCT** key and holding for at least 2 seconds.

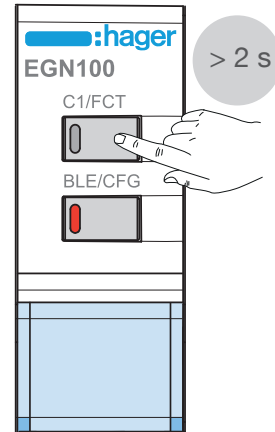

**5** Confirm the transmitter configuration by pulsing its **cfg** button.

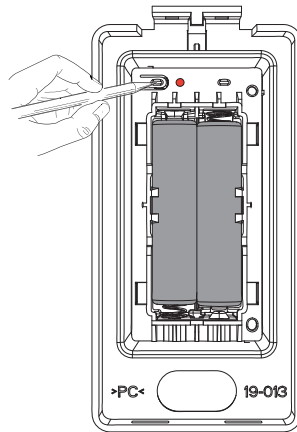

**For EGN200 and EGN400:**

**3** ① Open the **MENU**, ② select **Settings** then ③ press **OK** to confirm.

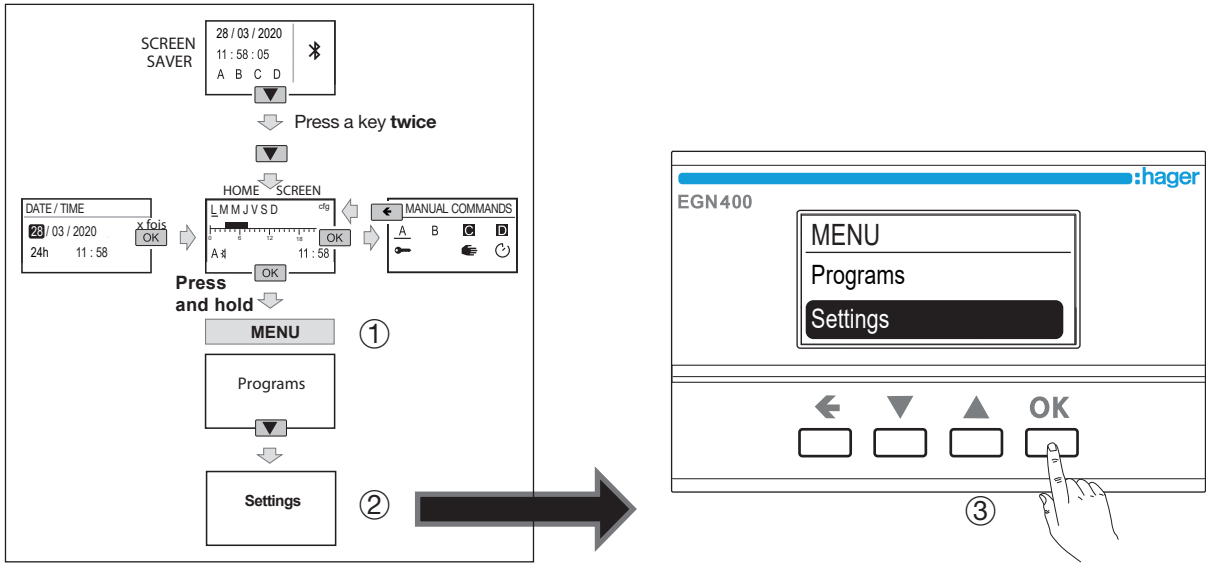

**4** Select **RF links**.

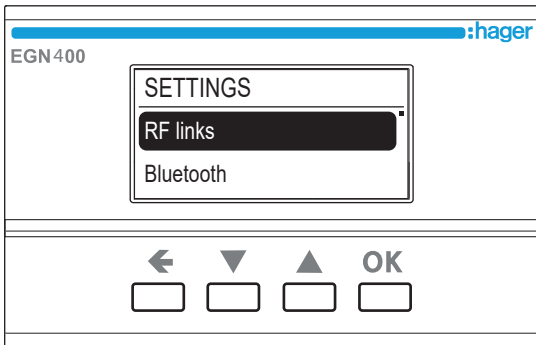

**5** Select the **output**.

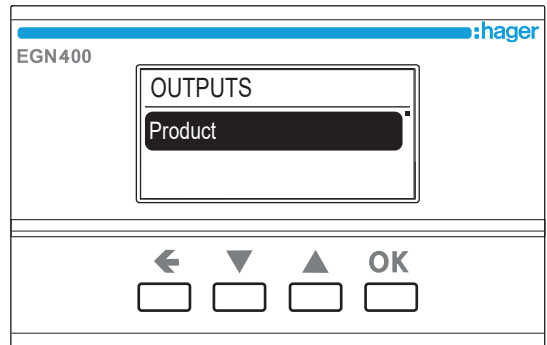

**6** Select the function, then press **OK** to confirm your selection and return to the **RF links** menu.

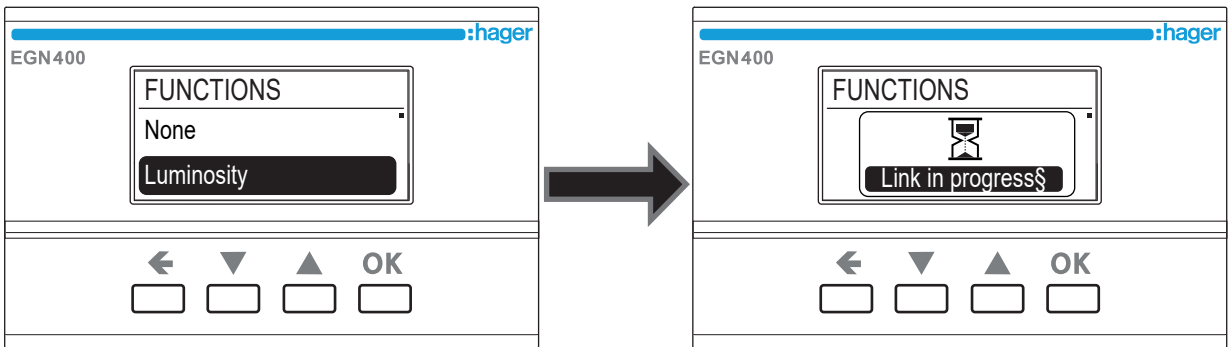

**7** Select the output. The symbol displayed indicates the link with the transmitter input (Quicklink radio comfort device) has been established.

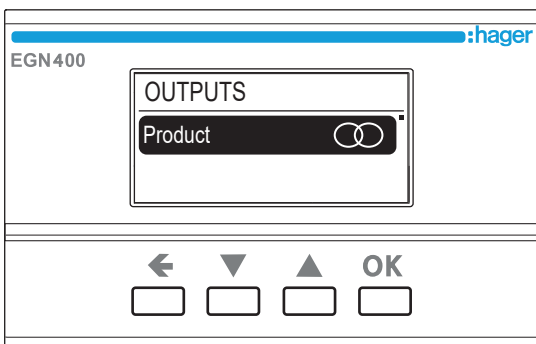

**8** Confirm the transmitter configuration by pulsing its **cfg** button.

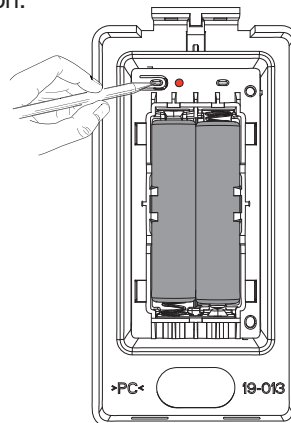

# 10. Integration with Coviva (TKP100A + Coviva app)

1 Add a comfort device to Coviva: in the My Devices section, tap the blue "+" sign.

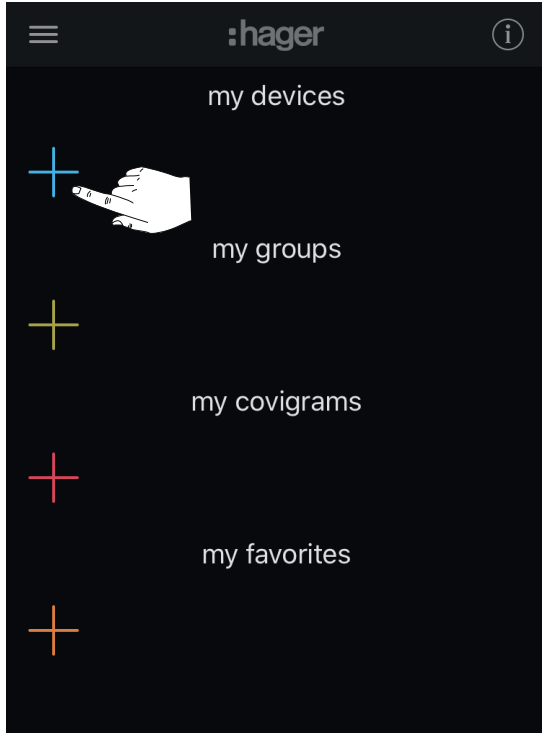

2 Tap Scan to begin searching for the device.

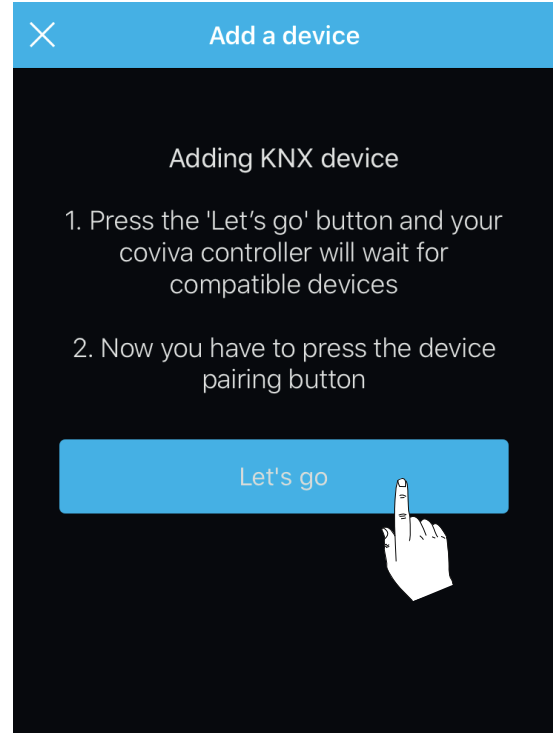

**i** All time switches (output) enter configuration mode.

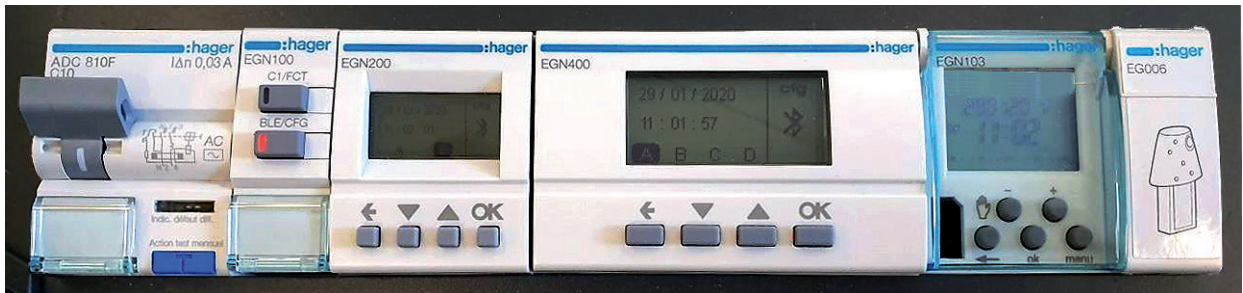

2 To pair the device, follow the configuration procedure for your time switch (EGN100 or EGN200/400) (see next page).

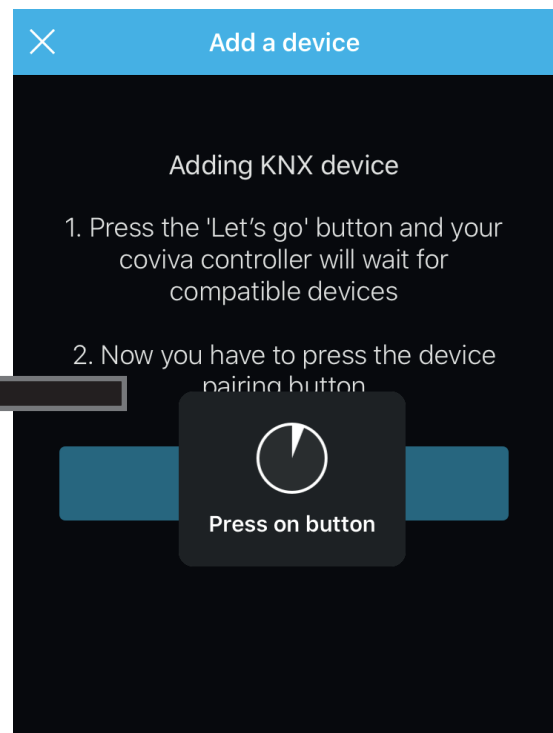

## For EGN100:

3 Press the **FCT** key.

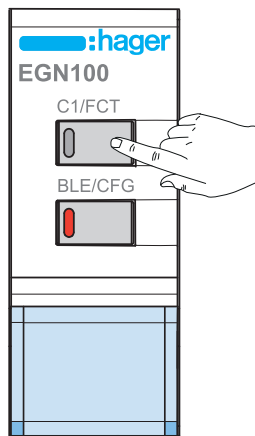

4 Once the device is recognized, its ID appears on the screen.  
Select the output function on the time switch.

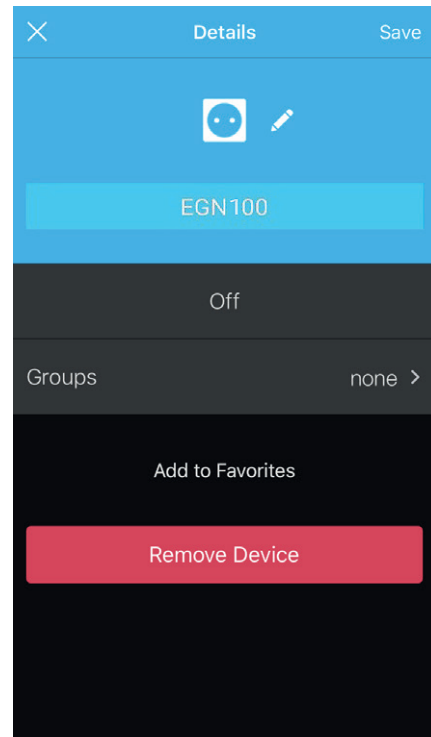

**For EGN200 and EGN400:**

**3** ① Open the **MENU**, ② select **Settings** then ③ press **OK** to confirm.

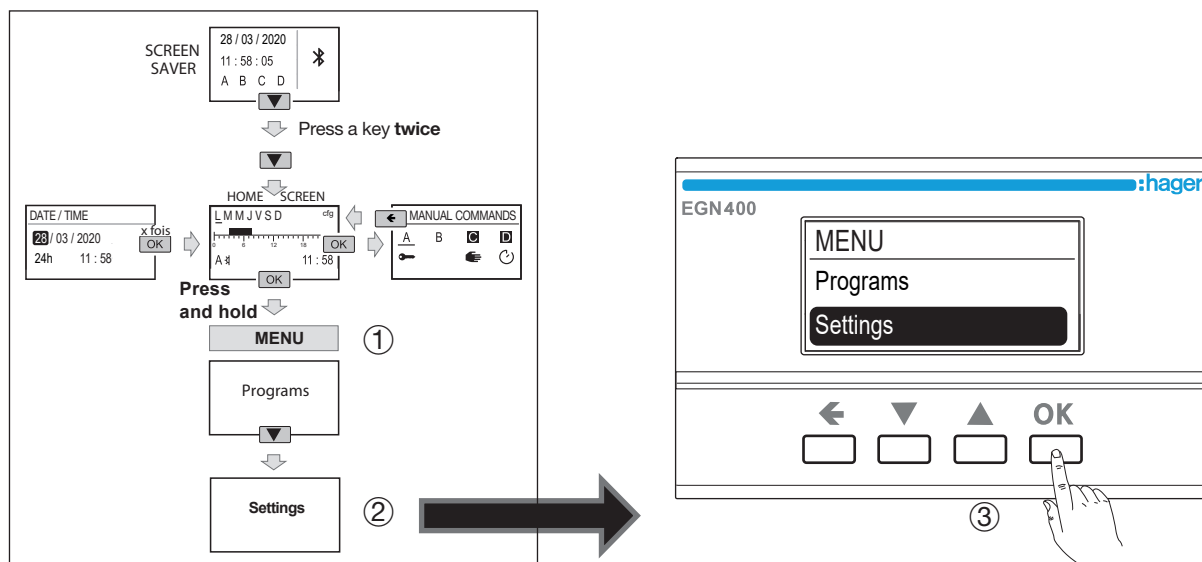

**4** Select **RF links**.

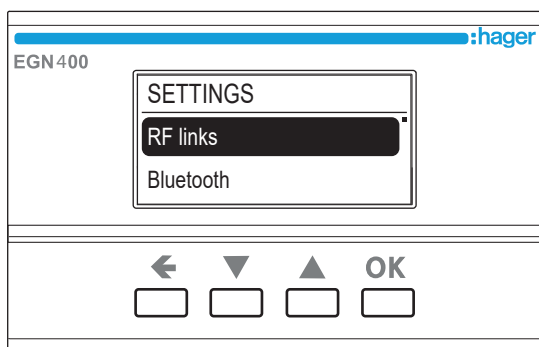

**5** Select the **output**.

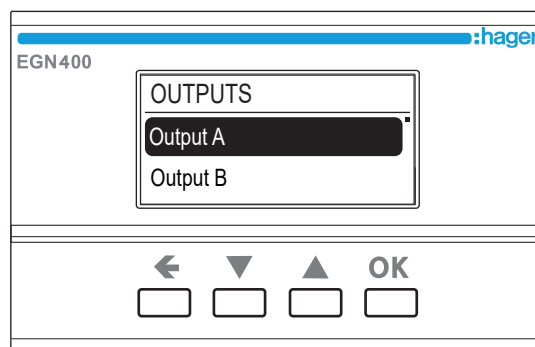

**6** Once the device is recognized, its ID appears on the screen. Select the output function on the time switch.

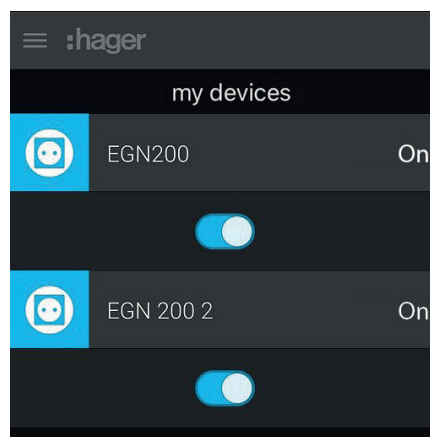
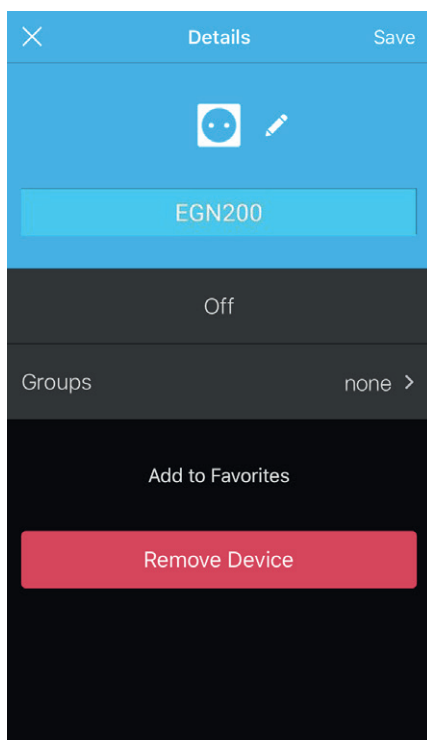

**7** Perform the same operation for all EGN200 and EGN400 outputs.

## 11. Updating device firmware

Use the **Hager Mood** app to keep the firmware in your device up to date.

1 On the home screen, tap the **device icon** to begin.

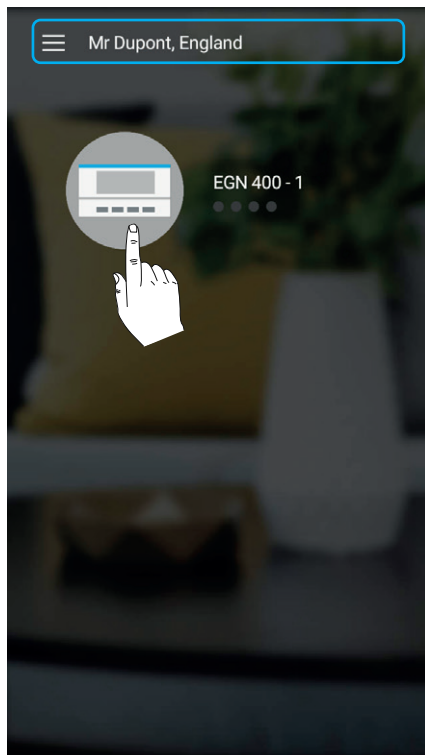

2 Then tap the **device settings** symbol.

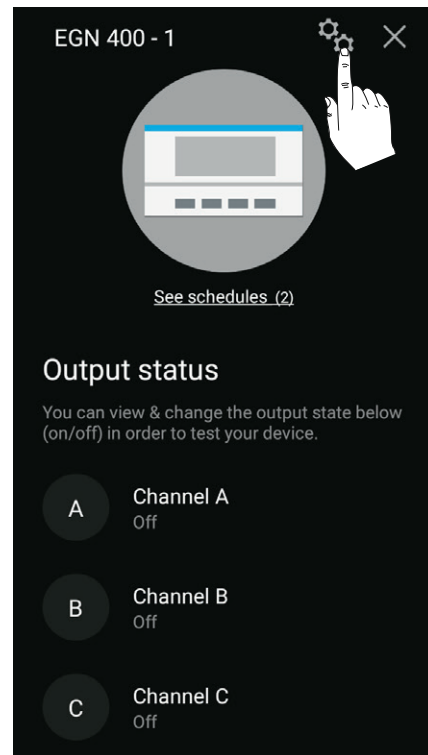

3 In the **Firmware tab**, tap **New version available**.

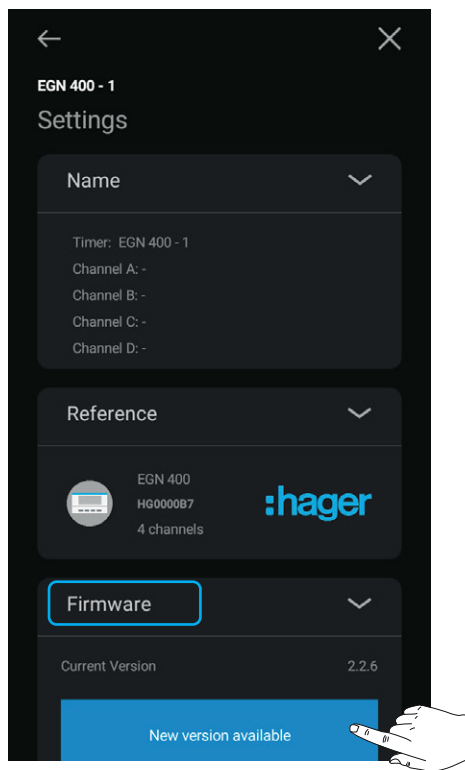



EGN100



EGN200/400



EGN003



EGN103



Scan the appropriate QR Code with your mobile device for more information.



**How to dispose of this product** (waste electrical and electronic equipment). (Applicable in the countries of the European Union and other European countries with separated waste collection systems). When displayed on a device or the documents accompanying it, the symbol opposite indicates that the device must not be disposed of with household waste when it reaches the end of its service life. As uncontrolled disposal of waste can harm the environment and human health, please separate it from other types of waste and recycle it responsibly. That way you'll help promote the sustainable reuse of material resources. Domestic users are advised to contact the dealer who sold them the device or their local authorities for instructions on where and how they can dispose of this device, so it can be recycled in an environmentally responsible manner. Business users should contact their suppliers and consult the terms and conditions of their sales agreements. This device must not be disposed of with other commercial waste.

**Hager Controls hereby declares that its EGN100, EGN200 and EGN400 wireless time switches comply with the essential requirements and other relevant provisions of Directive EU/2014/53. Our EC declaration can be consulted at [www.hager.com](http://www.hager.com).**

Valid throughout the **€** and in Switzerland





Hager Controls S.A.S.  
33, rue Saint-Nicolas  
B.P. 10140  
67703 SAVERNE CEDEX  
France - [www.hager.fr](http://www.hager.fr)