

6LE001627Ae

h3+
P250

3P-4P

x1

x2 (3P)
x3 (4P)

100

x6 (3P)
x8 (4P)

x2

MCCB 3P ENERGY

HTC160H

Tools:

- Wire cutters
- Screwdriver 2, 3
- Screwdriver PH 2
- Hex key 4, 5, 6, 8, 10

Dimensions:

	A (mm)
3P	105
4P	140

	B (mm)
TM-LSI	72,5
Energy	74,5

Mounting:

M4

35

126

PH2

1 Nm

Operation Sequence:

TRIP → OFF → ON → TRIP → OFF

Click!

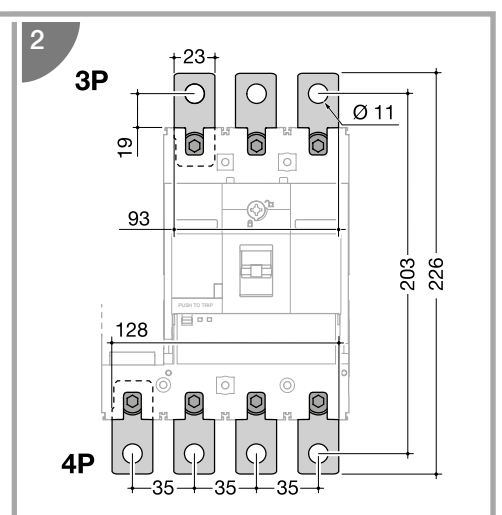
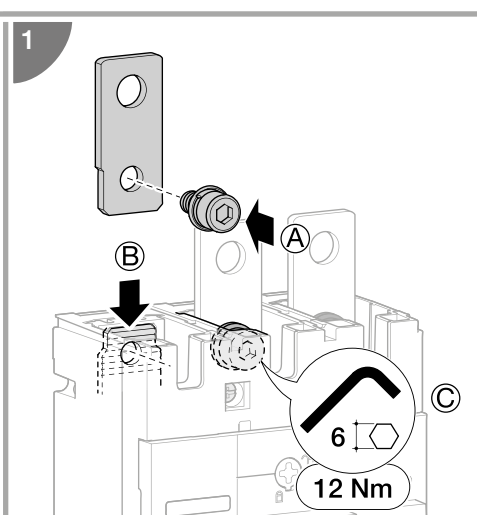
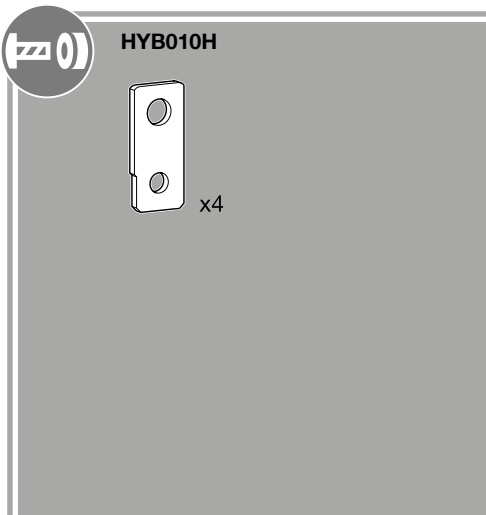
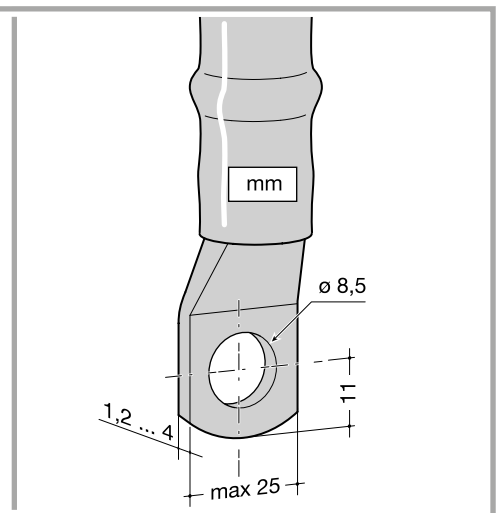
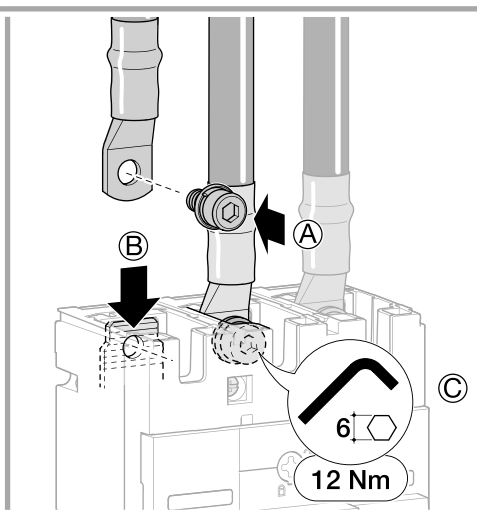
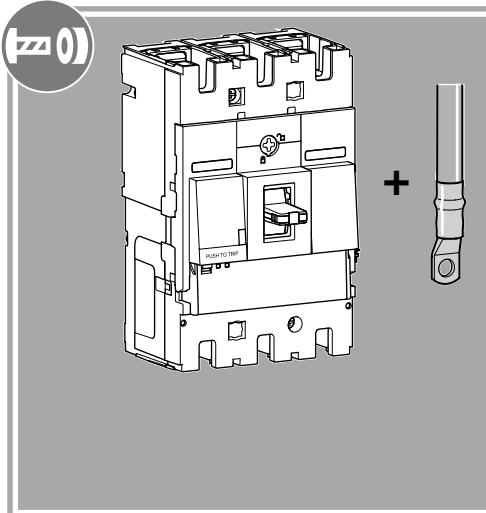
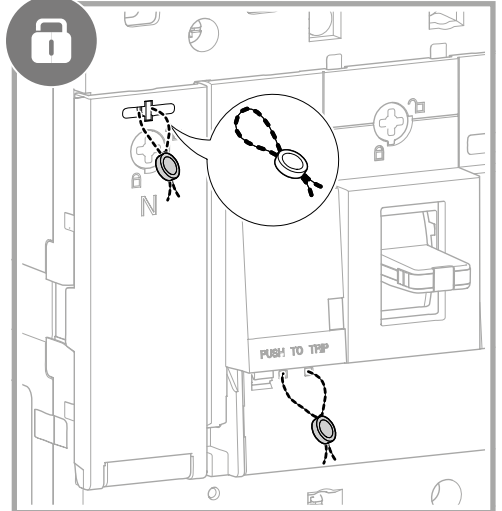
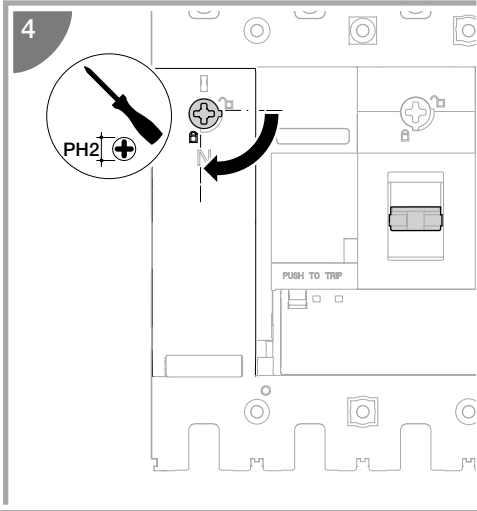
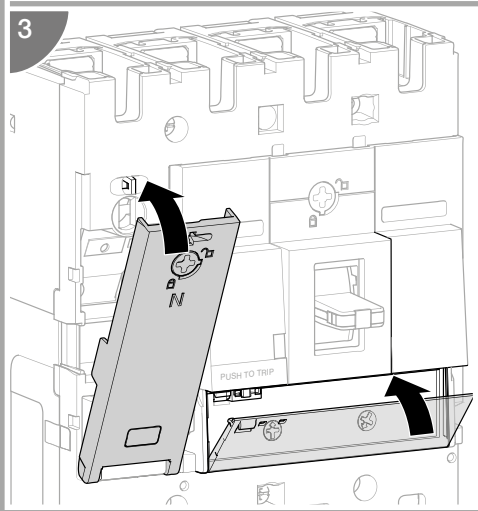
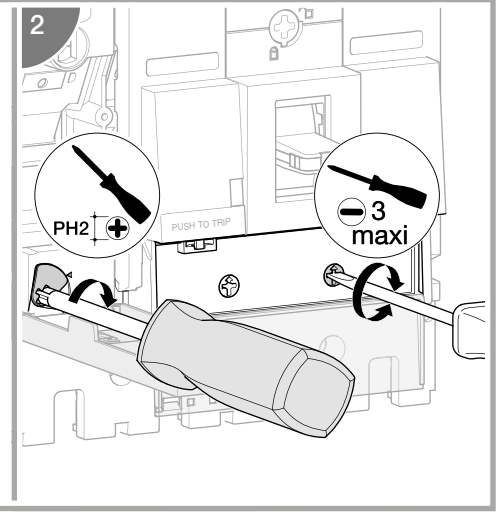
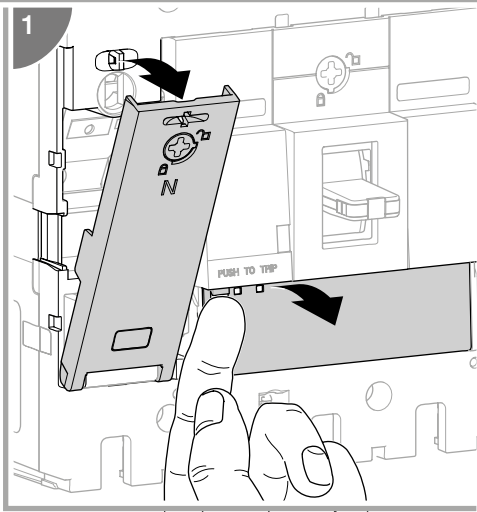
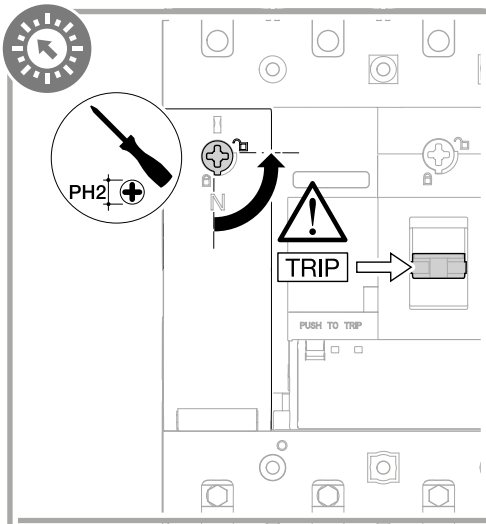



HYB011H (3P)

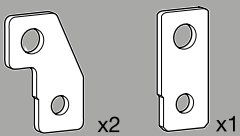

HYB012H (4P)

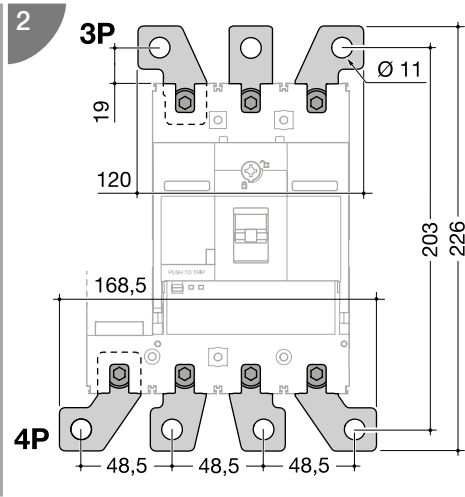
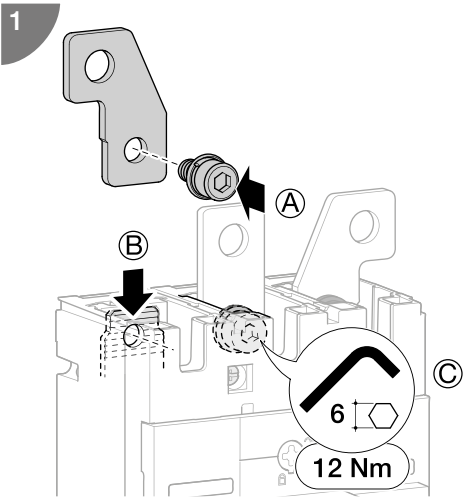
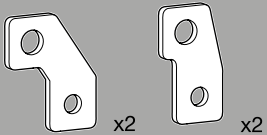

**HYB031H (3P)
HYB032H (4P)**

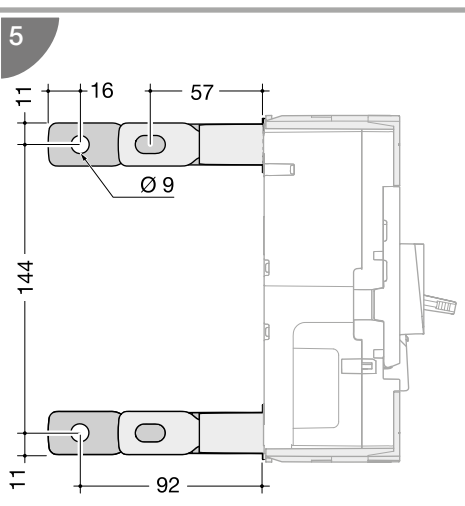
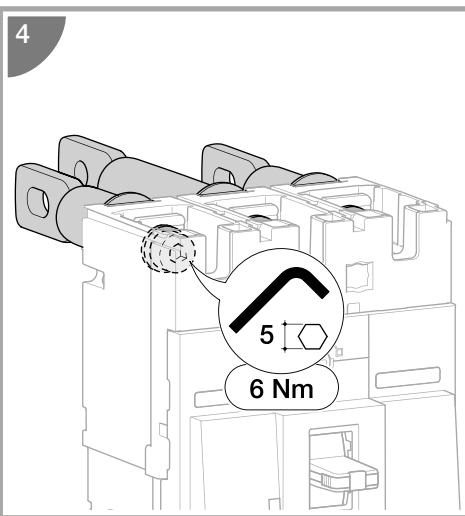
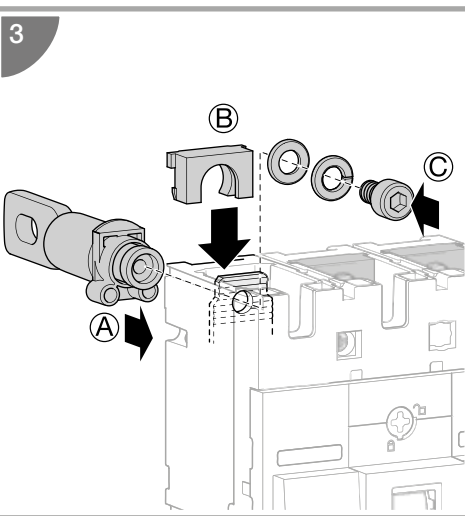
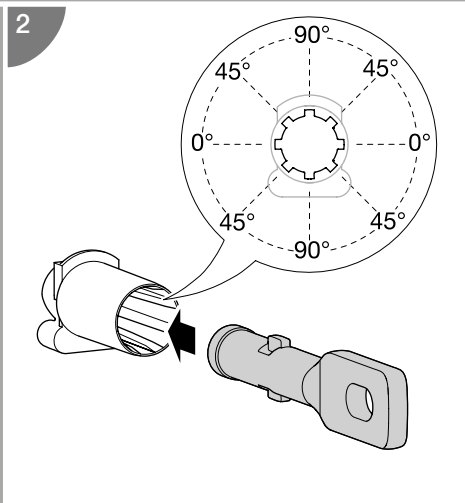
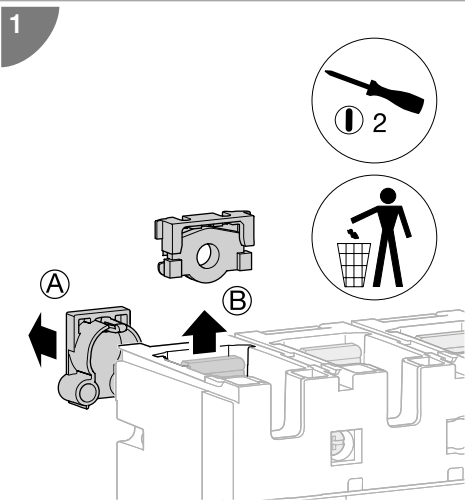
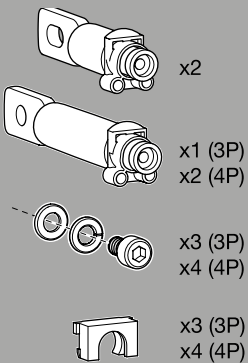



HYT001H (3P)
HYT002H (4P)

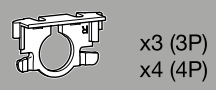
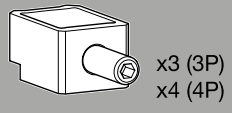

+
Cu
Al

	min.	max.
	(mm ²)	
	10	120
	10	150

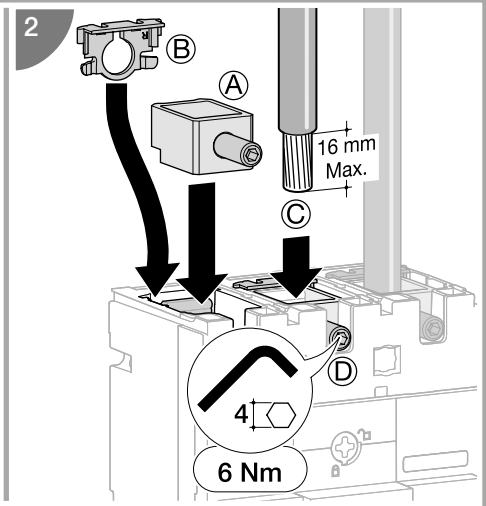
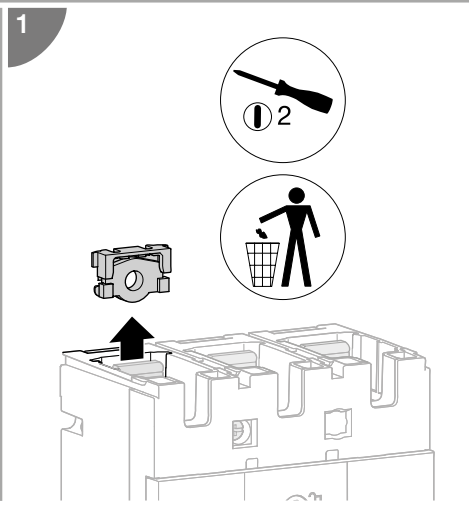

HYT005H (3P)
HYT006H (4P)

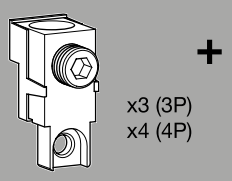

x3 (3P)
x4 (4P)

+
Cu
Al

	min.	max.
	(mm ²)	
	50	185
	50	185

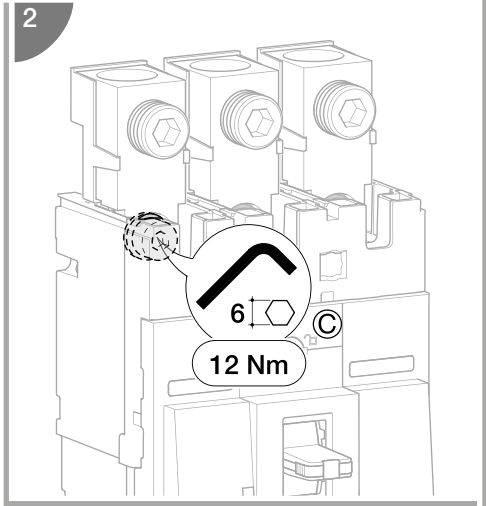
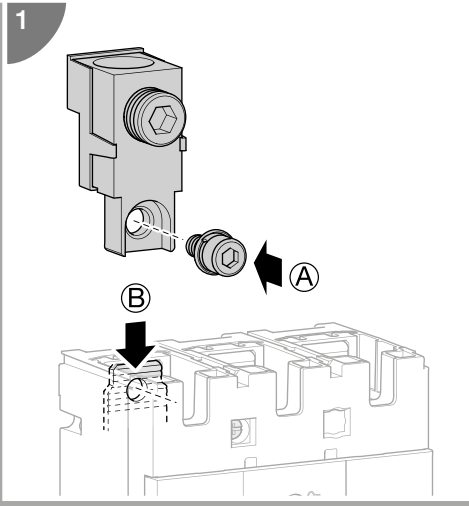

HYT007H (3P)
HYT008H (4P)

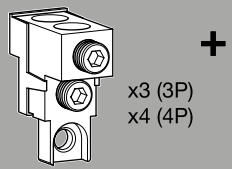

x3 (3P)
x4 (4P)

+
Cu
Al

	min.	max.
	(mm ²)	
	35	95
	35	120

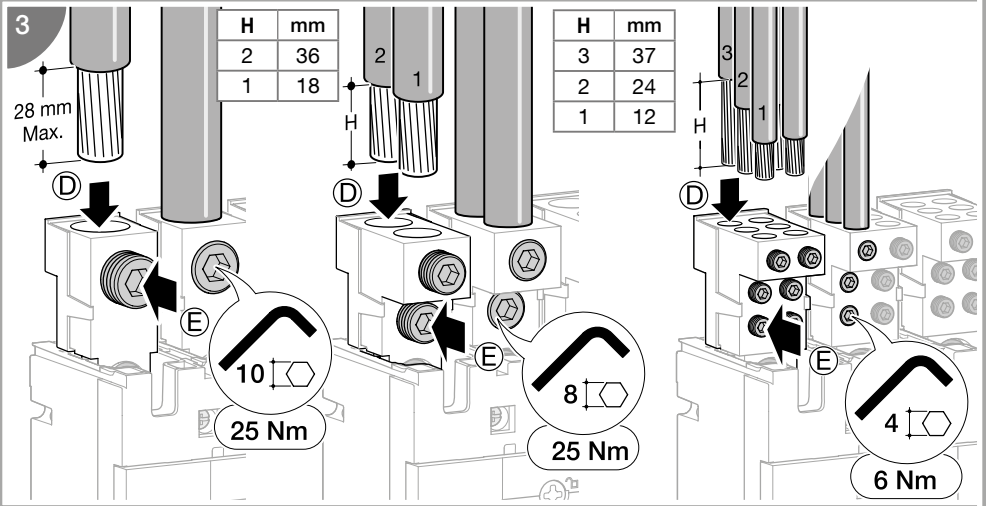

HYT065H (3P)
HYT066H (4P)

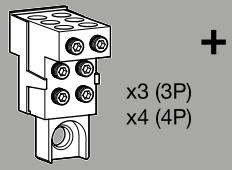

x3 (3P)
x4 (4P)

+
Cu
Al

	min.	max.
	(mm ²)	
	6	35
	6	35

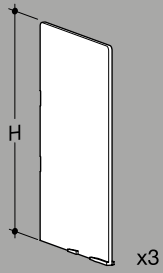

	H (mm)
	100
3P/4P	HYT019H

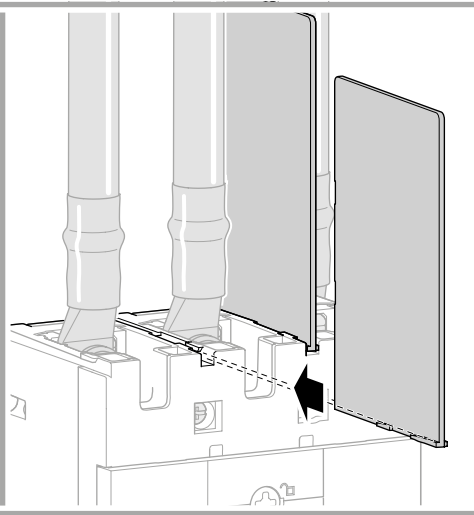

HYT050H (3P)
HYT051H (4P)

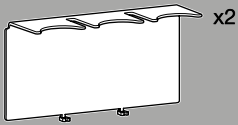

HYT021H (3P)
HYT022H (4P)

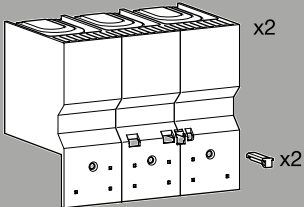

HYT052H (3P)
HYT053H (4P)

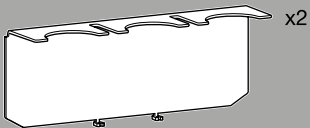

HYT023H (3P)
HYT024H (4P)

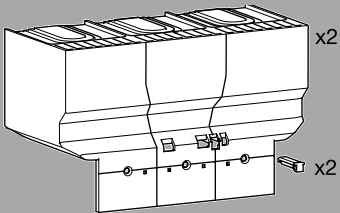

HYT025H (3P)
HYT026H (4P)

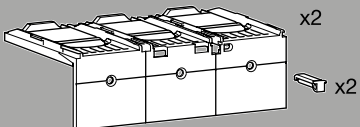

1

(A)

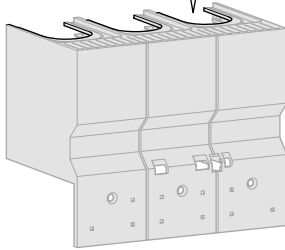
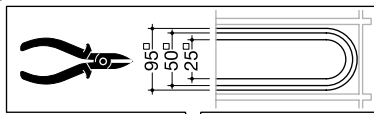

(B)

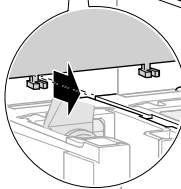

(C)

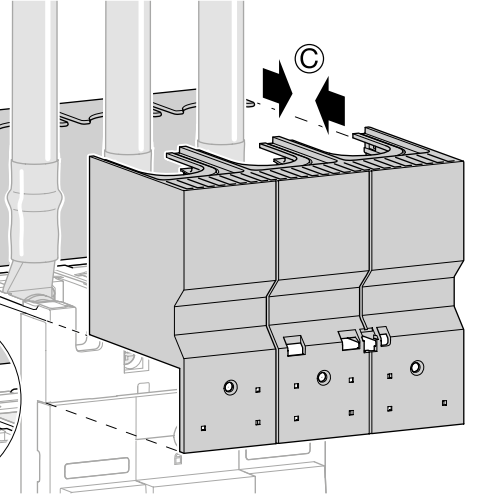

2

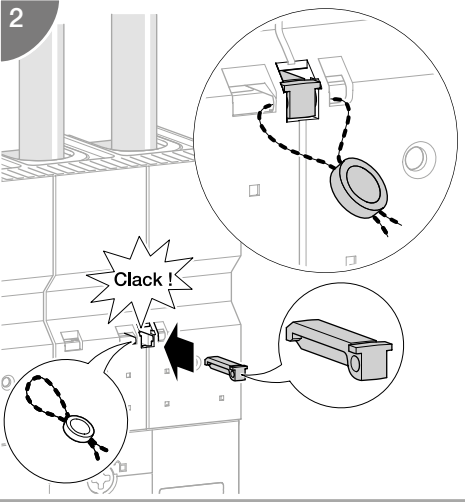

3

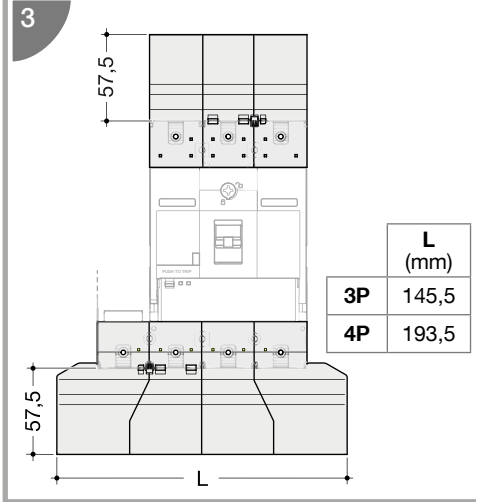

	L (mm)
3P	145,5
4P	193,5

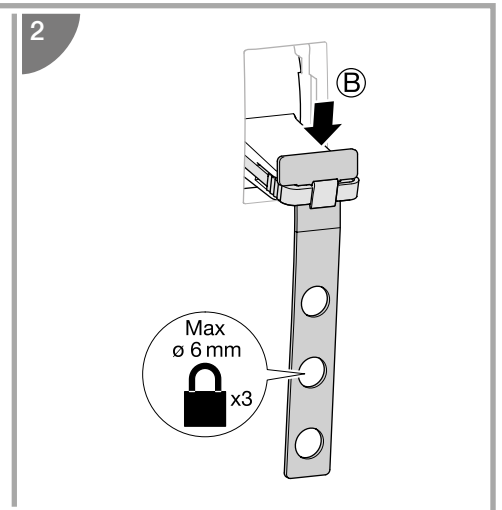
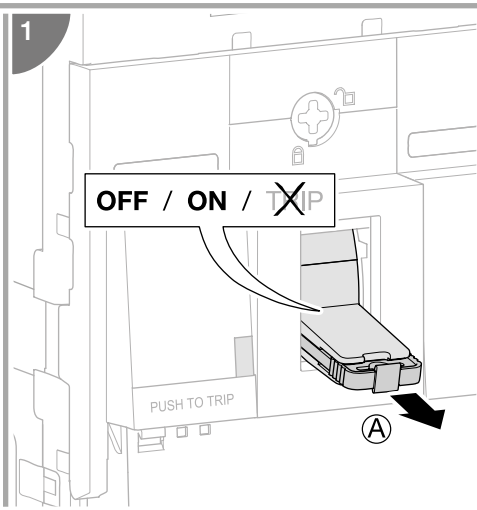
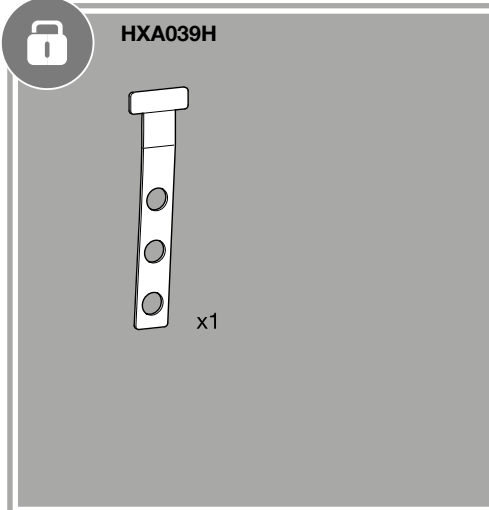
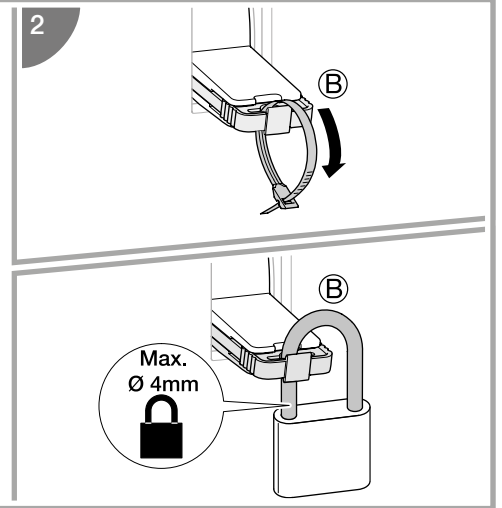
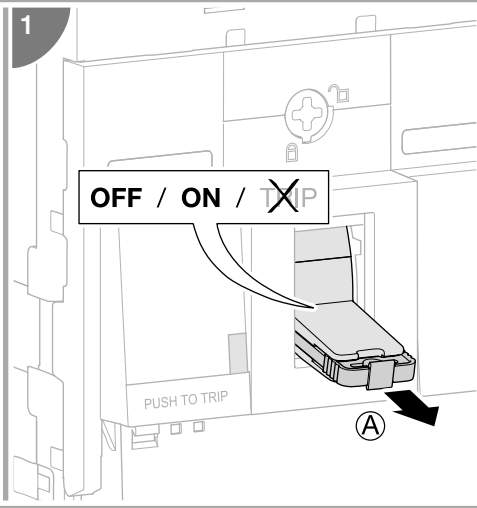
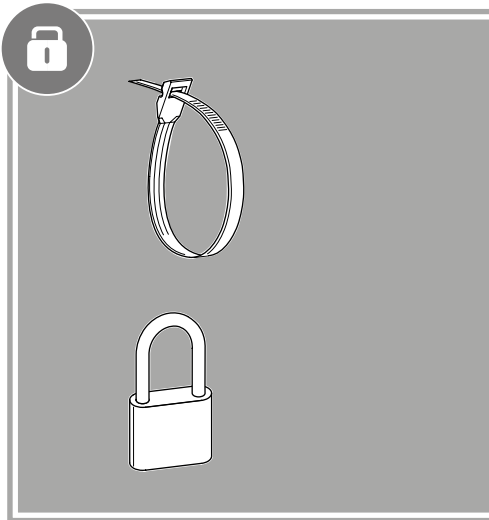

Diagram showing a checklist icon in the top left corner of a large empty rectangular area, intended for user notes or a checklist.