

# Front Mounting Switches

# sälzer

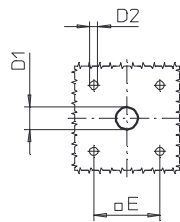
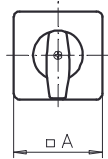
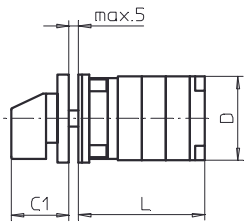
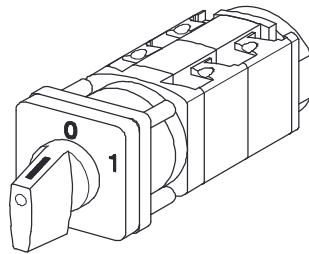

**Product line**  
**P200**

**Front mounting switch**

**Four hole mounting**  
36 x 36 mm

**003M1 (IP66)**

Complete switch	Poles	Product line	Rated data (IEC 60947)			Order code number								
			Operational current I <sub>o</sub>	Operational power at 380–440 V										
			AC-21A A	AC-23A kW	AC-3 kW									
Rotary Cam Switches Switching angle 30°/45°/60°/90°	1 ... 24	P200	20 25	7,5 11	5,5 7,5	<b>P220 - 61 ... - 003M1</b> <b>P225 - 61 ... - 003M1</b>								
<b>SMD modules for basic switch A01</b>														
Mounting form module for 003M1			P200			<b>BFB2 - 003</b>								
M-operator module 48 x 48 mm, mounting form 003M1						<b>2AM1</b>								
Escutcheon black, handle black														
Legend plate silver, operator module 003M1						<b>FAS2 - .... (FA number)</b>								
<b>Dimensions (mm)</b>														
<b>Type</b>	<b>A</b>	<b>C1</b>	<b>D</b>	<b>D1</b>	<b>D2</b>	<b>E</b>	L with ... stages (max. 12)							<b>each add. stage</b>
							<b>1</b>	<b>2</b>	<b>3</b>	<b>4</b>	<b>5</b>	<b>6</b>	<b>7</b>	
P220	48	32	44	12	4,5	36	47	60	73	86	99	112	125	13
P221	48	32	44	12	4,5	36	50,5	67	83,5	100	116,5	133	149,5	16,5
P225	48	32	46	12	4,5	36	51	66	81	96	111	126	141	15
P226	48	32	46	12	4,5	36	54,5	73	91,5	110	128,5	147	165,5	18,5