

Front Mounting Switches

sälzer

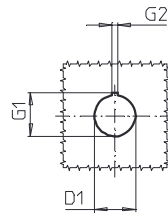
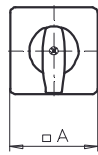
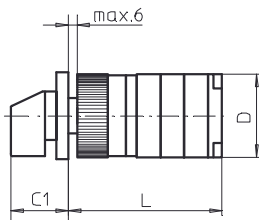
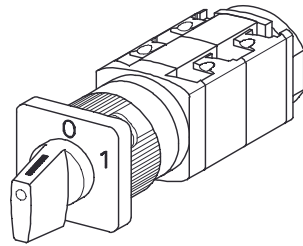

**Product line
P200**

Front mounting switch

Single hole mounting
ø 22,5 mm

219M1 (IP66)

Complete switch	Poles	Product line	Rated data (IEC 60947)			Order code number								
			Operational current I _e		Operational power at 380–440 V									
			AC-21A A	AC-23A kW	AC-3 kW									
Rotary Cam Switches Switching angle 30°/45°/60°/90°	1 ... 24	P200	20 25	7,5 11	5,5 7,5	P220 - 61 ... - 219M1 P225 - 61 ... - 219M1								
SMD modules for basic switch A01														
Mounting form module for 219M1			P200			BFB2 - 219								
M-operator module 48 x 48 mm, mounting form 219M1						2DM1								
Escutcheon black, handle black														
Legend plate silver, operator module 219M1						FAS2 - (FA number)								
Dimensions (mm)														
Type	A	C1	D	D1	G1	G2	L with ... stages (max. 12)						each add. stage	
							1	2	3	4	5	6		7
P220	48	32	44	22,5	24,2	3,2	66	79	92	105	118	131	144	13
P221	48	32	44	22,5	24,2	3,2	69,5	86	102,5	119	135,5	152	168,5	16,5
P225	48	32	46	22,5	24,2	3,2	70	85	100	115	130	145	160	15
P226	48	32	46	22,5	24,2	3,2	73,5	92	110,5	129	147,5	166	184,5	18,5